

PORCELANOSA FACADE/

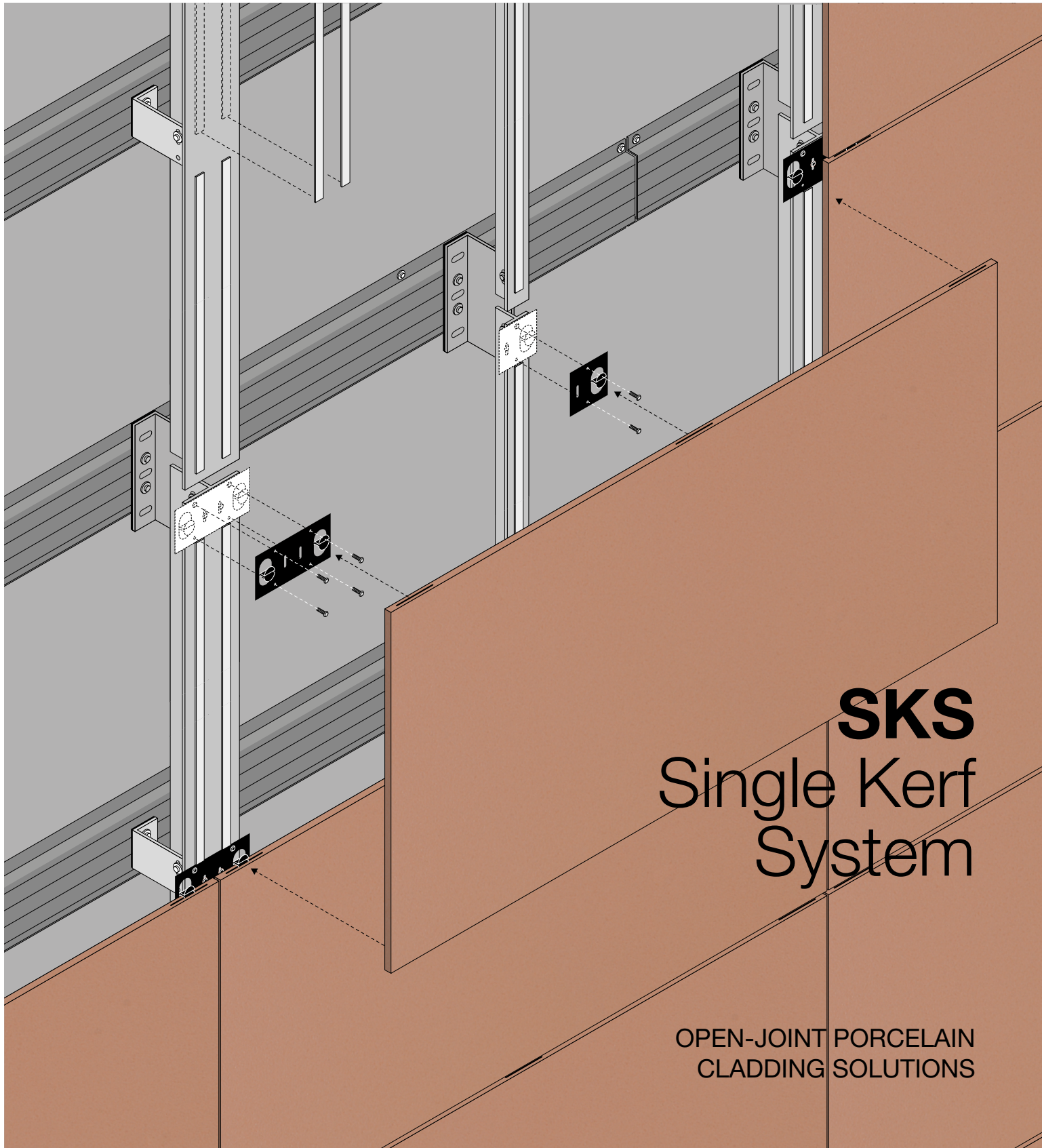

SKS
Single Kerf
System

OPEN-JOINT PORCELAIN
CLADDING SOLUTIONS

SKS / Single Kerf System

ELEVATE YOUR VISION BUILD WITHOUT LIMITS

The SKS - Single Kerf System is a ventilated façade solution developed by Porcelanosa for pre-set size porcelain cladding. This advanced façade system optimizes thermal efficiency and visual impact, providing architects and installers with a resilient solution for modern building envelopes.

A SECURE SYSTEM A PRECISE FAÇADE

SKS is a mechanical concealed fixing system that uses a discreet substructure and aluminium clips that anchor into cut single kerfs on the edge of Porcelanosa porcelain panels.

The system ensures secure, seamless installation combining timeless elegance to elevate any architectural vision.

WHY CHOOSE SKS-SINGLE KERF SYSTEM?

- Trusted by Design**
Unlimited finishes by Porcelanosa Grupo
- Certified System**
Backed by industry standards and rigorous testing certified systems.
- Concealed Fixing**
Invisible mechanical clips ensure a clean, secure installation.
- Thermal & Acoustic Performance:**
Enhances insulation and energy efficiency.
- Durability**
Resistant to water, UV exposure, and fire.
- High Wind Load Resistance**
Ideal for tall buildings and exposed environments.











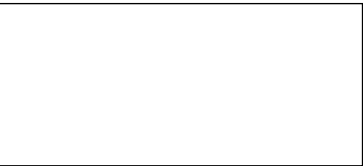

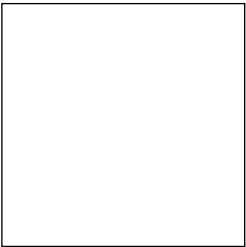
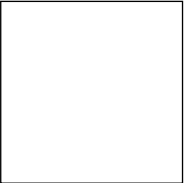



Design
your Porcelain
Program
+15,000 SF

CREATE A SIGNATURE LOOK FOR YOUR PROJECT

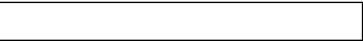
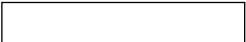
For façade designs exceeding **15,000 sf** in regular format panels, Porcelanosa offers the opportunity to co-design your own exclusive porcelain panels — a truly unique finish for landmark architecture. Bring your creative vision to life with personalized textures, tones, and dimensions.

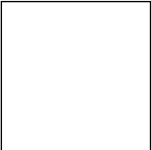
Panel Sizes Available

Regular Format PRE-SET SIZED MOLD TECHNOLOGY

 71" x 31"	 59" x 20"	 48" x 48"	 39" x 39"
 71" x 24"	 59" x 10"	 48" x 24"	 39" x 20"
 71" x 12"	 59" x 6"	 48" x 12"	
 71" x 8"		 48" x 8-6"	
 36" x 18"	 32" x 32"	 24" x 24"	
 36" x 9"	 32" x 16"		
 36" x 6"			

SKS / Single Kerf System

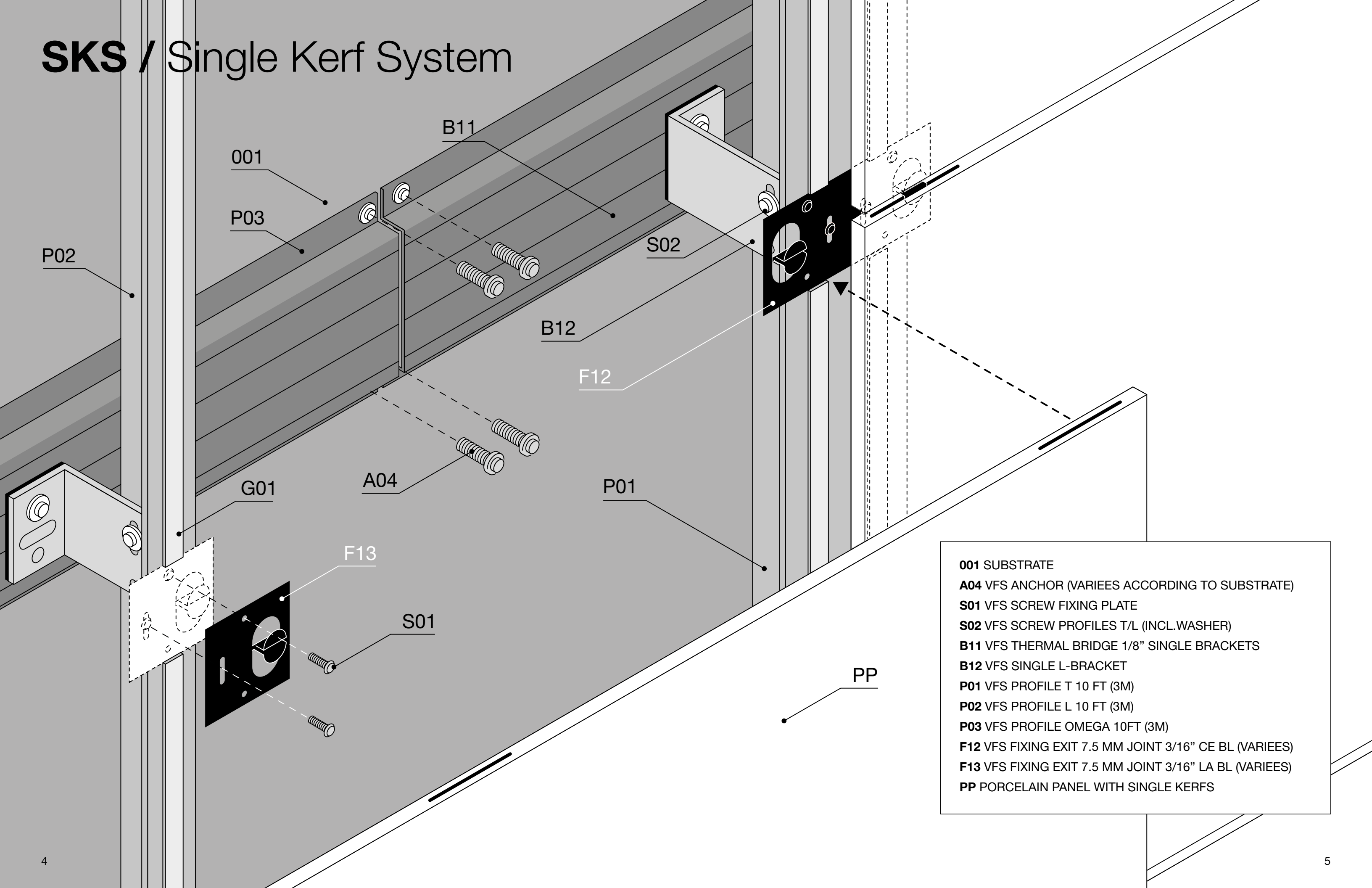

- 001** SUBSTRATE
- A04** VFS ANCHOR (VARIEES ACCORDING TO SUBSTRATE)
- S01** VFS SCREW FIXING PLATE
- S02** VFS SCREW PROFILES T/L (INCL.WASHER)
- B11** VFS THERMAL BRIDGE 1/8" SINGLE BRACKETS
- B12** VFS SINGLE L-BRACKET
- P01** VFS PROFILE T 10 FT (3M)
- P02** VFS PROFILE L 10 FT (3M)
- P03** VFS PROFILE OMEGA 10FT (3M)
- F12** VFS FIXING EXIT 7.5 MM JOINT 3/16" CE BL (VARIEES)
- F13** VFS FIXING EXIT 7.5 MM JOINT 3/16" LA BL (VARIEES)
- PP** PORCELAIN PANEL WITH SINGLE KERFS

SKS / Single Kerf System

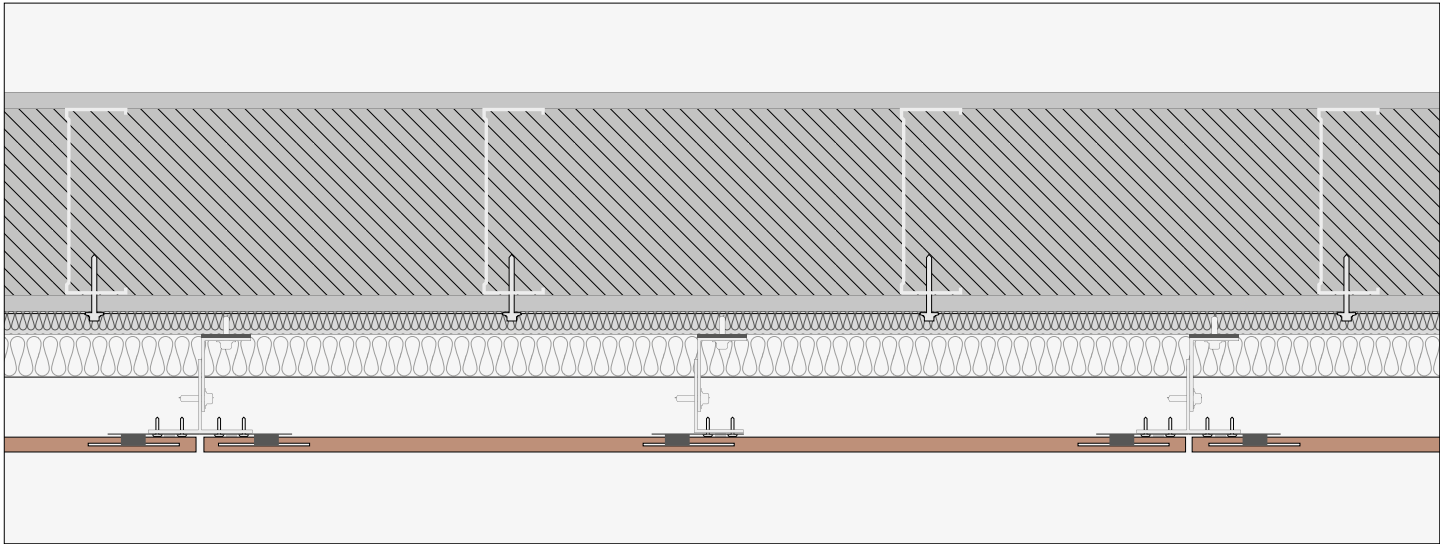

Horizontal Typical Detail.

SUBSTRUCTURE & BUILD-UP

The SKS system includes horizontal omegas, adjustable angle Brackets, vertical T-profiles, vertical L-profiles and fixing clips with different exits, in order to adapt to the required panel thickness. This build-up forms a ventilated cavity between the panel and the structural wall, letting space for the exterior insulation and ensures continuous airflow behind the cladding.

Adjustable brackets:

Single and double brackets available with projections of 1-9/16" (40 mm), 2-3/8" (60mm), 3-1/8"(80mm), 3-15/16(100mm), 4-3/4"(120m), 5-1/2"(140mm), 6-5/16"(160 mm) and customizable projections to match thermal and design requirements.

Max./Min. build-up:

The façade projection is configurable. It has min. build-up of 3-3/4". The recommended/typical build-up is 4-1/2".

Recommended cavity:

Minimum 1" (25 mm) air gap between insulation and panel.

TOLERANCE IN/AND OUT

The system is designed to absorb surface irregularities in the substrate, offering up to 3/4" (20 mm) of in-and-out adjustability through the brackets.

Typical joints

- Standard vertical and horizontal joint: 3/16"(5 mmm) or 5/16" (8 mm)

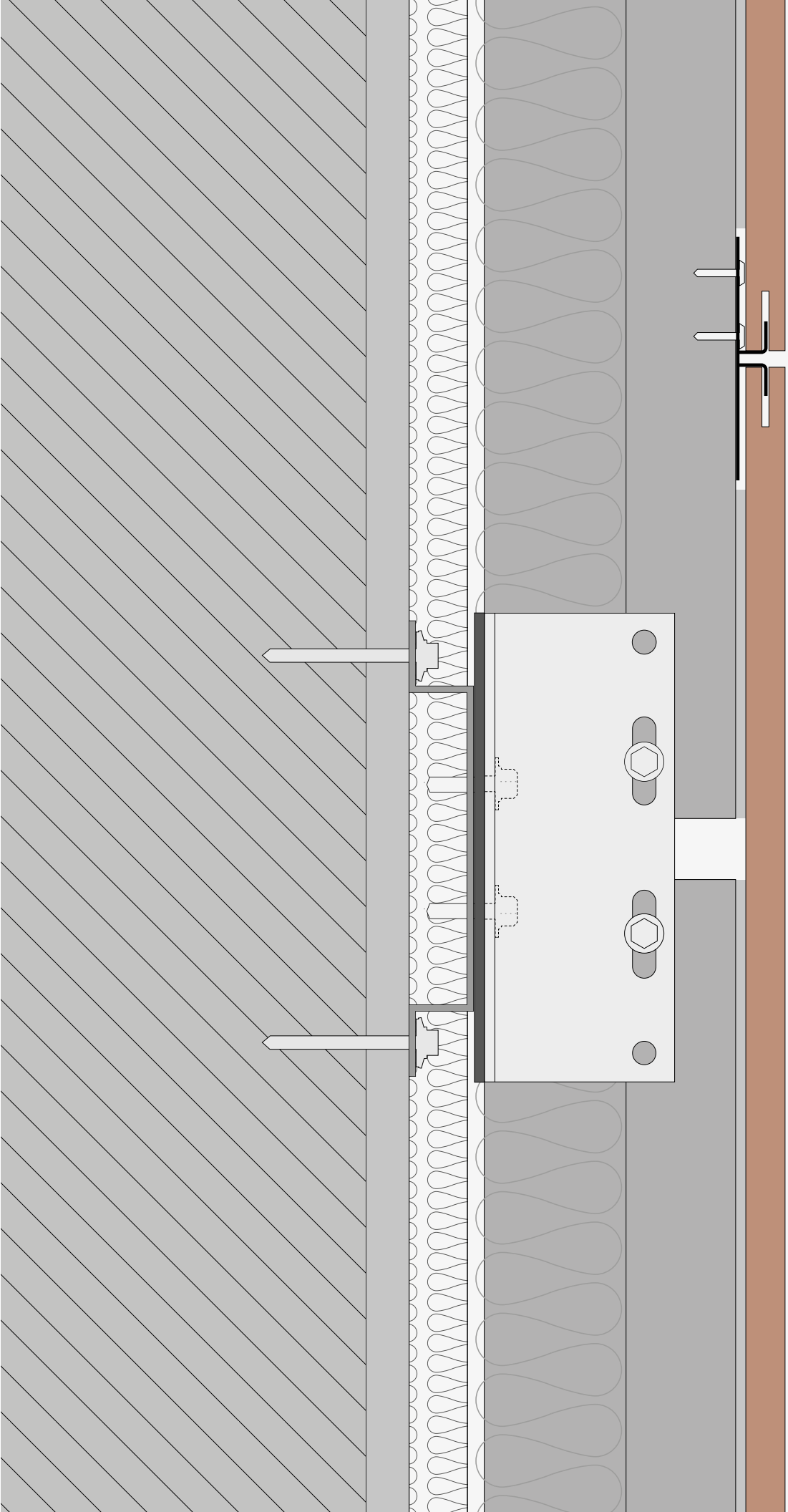

Vertical Typical Detail

SKS / Single Kerf System

1

Installation of horizontal omegas

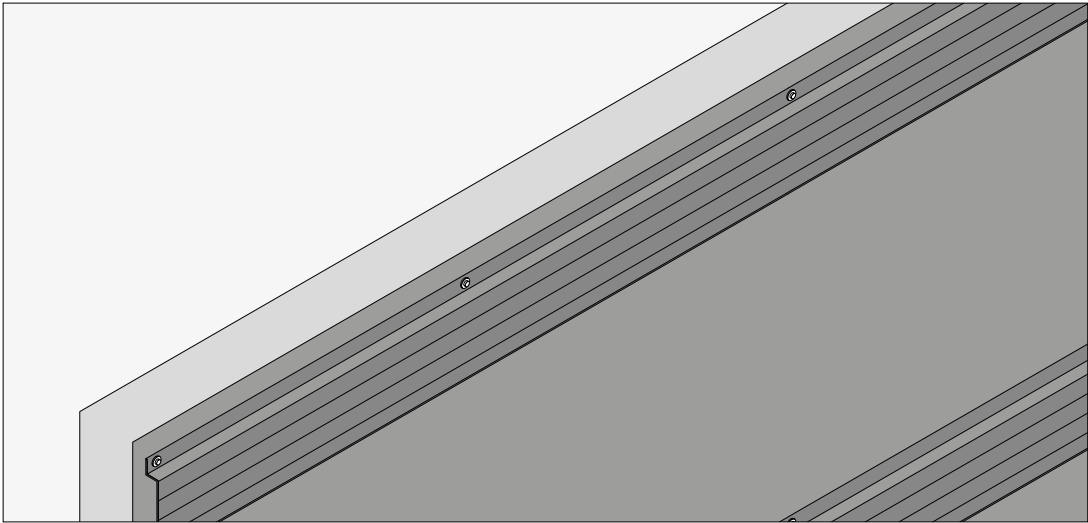

2

Installation of double and single brackets with its thermal breaks

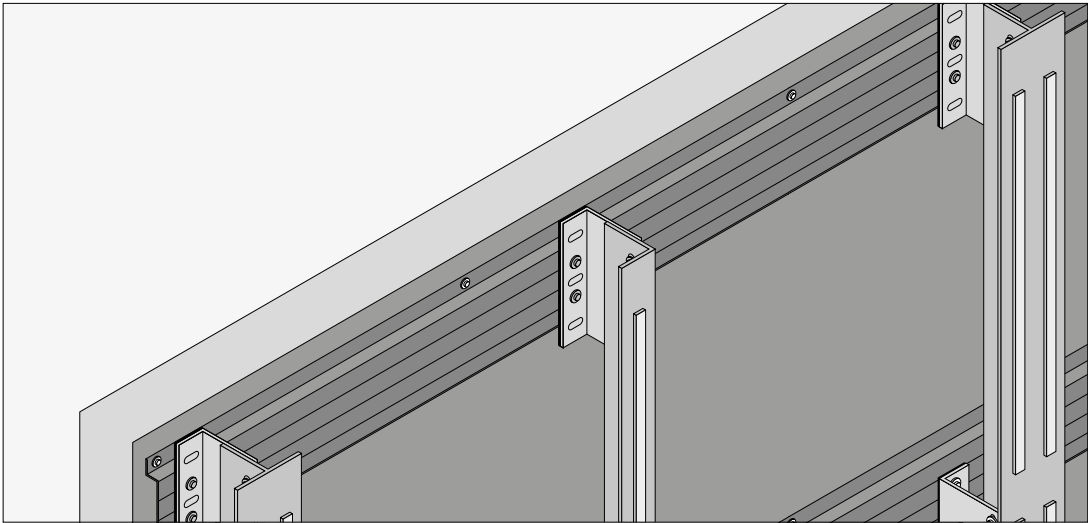

3

Installation of vertical L-profiles aligned with the position of the single kerfs, and placement of vertical T-profiles aligned with panel joints and their corresponding single kerfs.

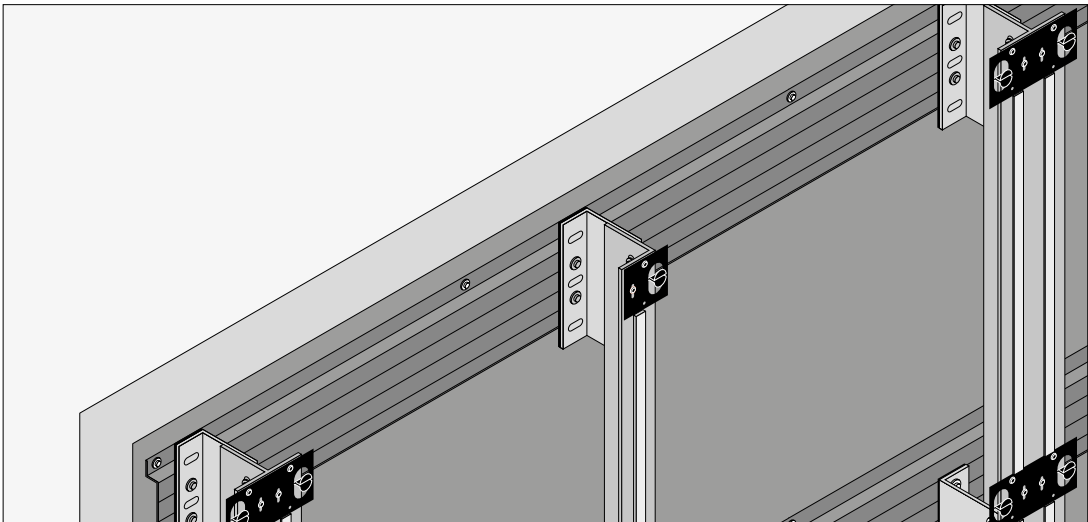

4

Placement of Porcelanosa porcelain panels according to façade layout

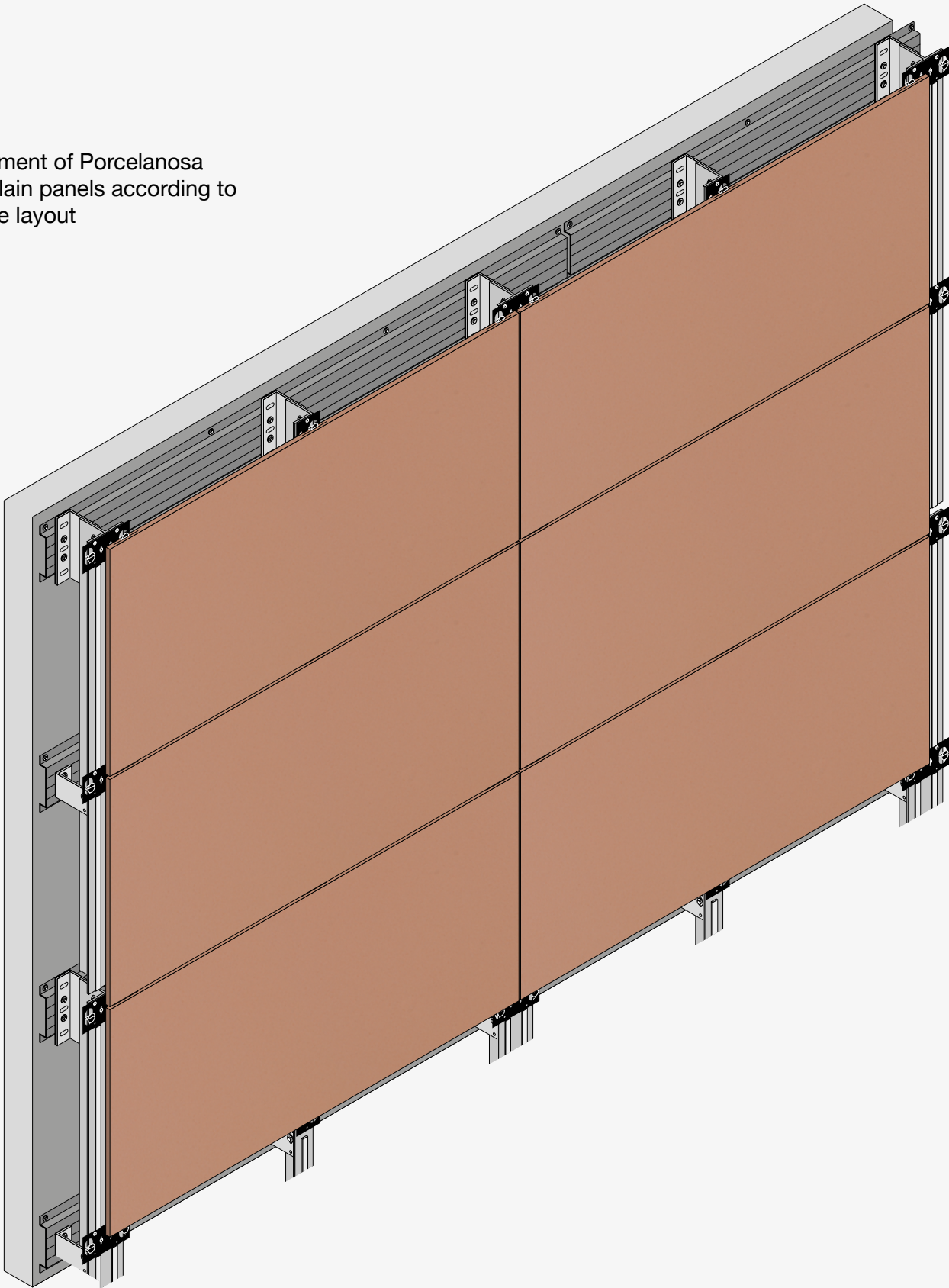

SKS / Single Kerf System

Every corner covered —
Technical details specifically designed to adapt to all façade situations.

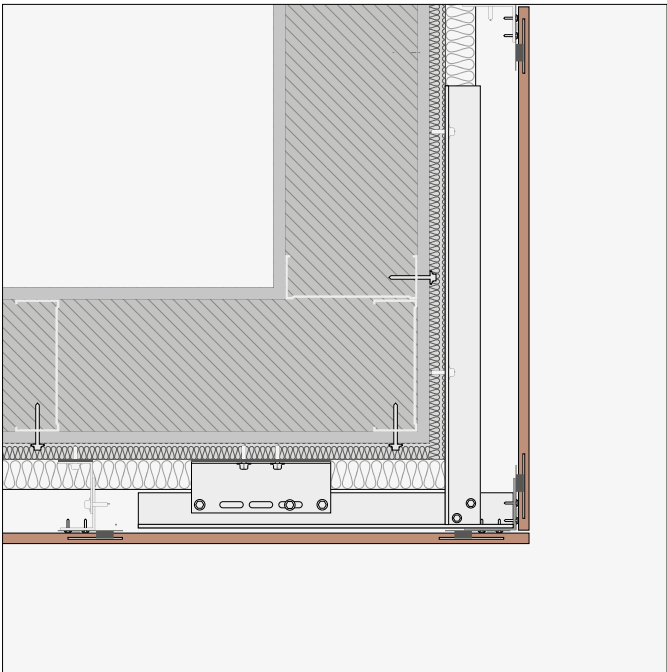

Outside Corner Detail

Total resolution of the façade —
Complete façade integration, edge to edge

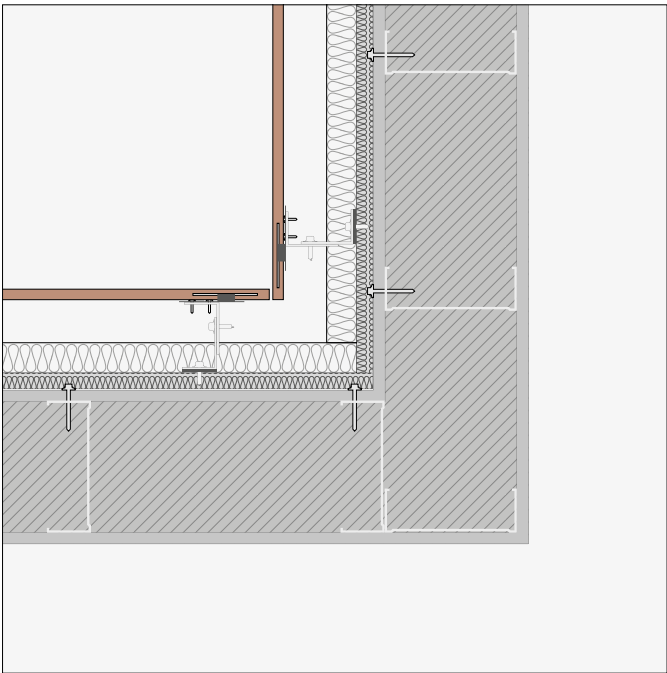

Inner Corner Detail

Type of Corners

Play and design with our different type of corners. Choose elegant solutions with the typical corner, mitered corners and recessed corners.

Recessed corners are ideal for seismic zones.

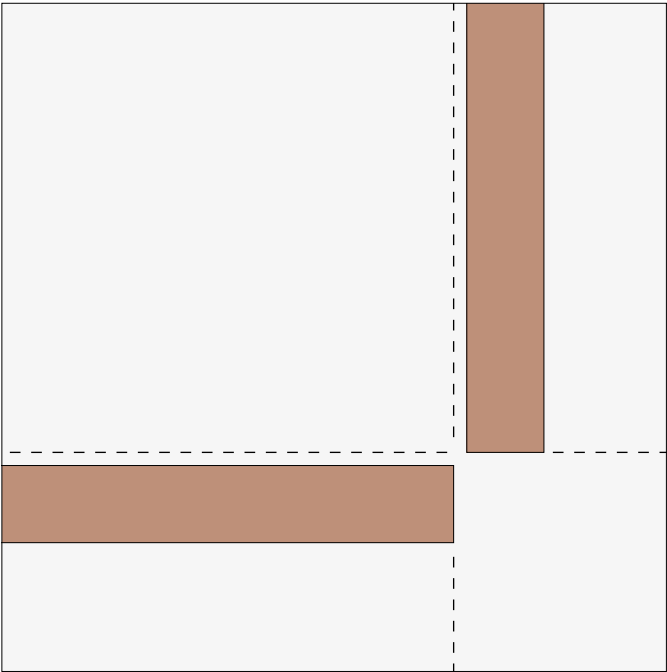

Recessed Corner

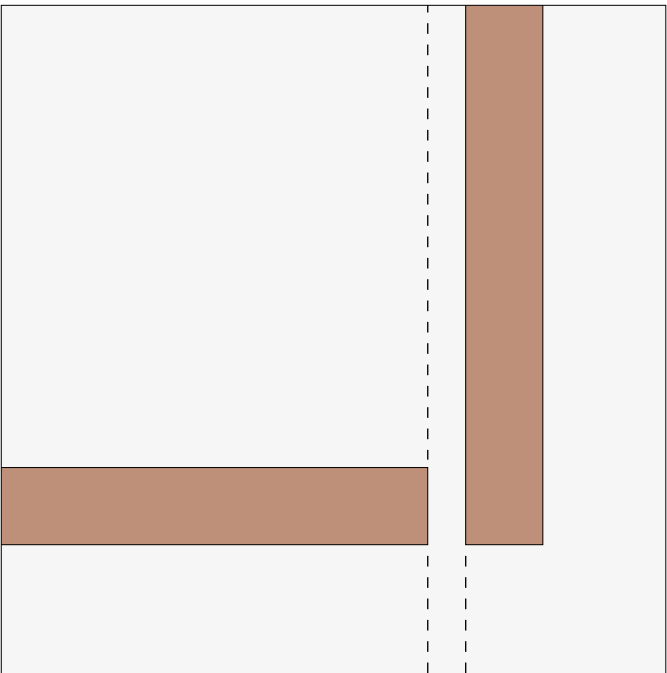

Typical Corner

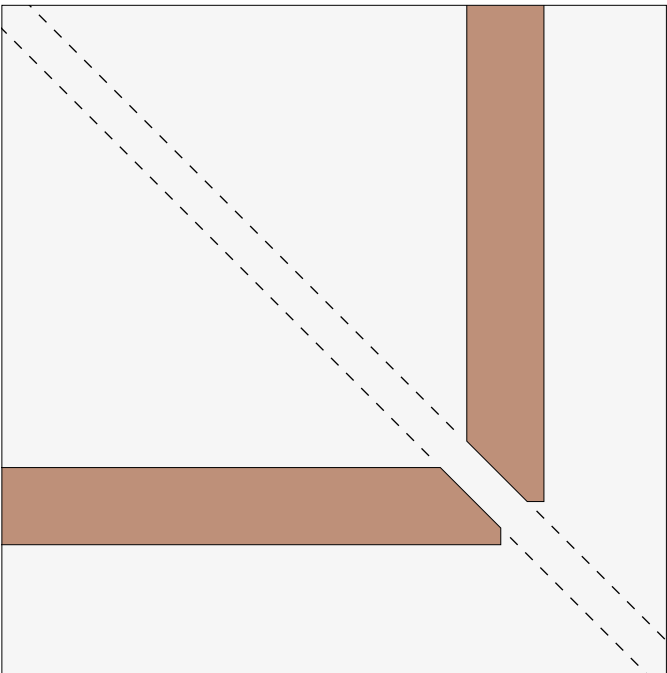

Mitered Corner

SKS / Single Kerf System

Opening Solutions

Clad all your vertical returns and horizontal heads of all the openings of your project with our solutions.
Take into account min. width returns of 3-5/8”.

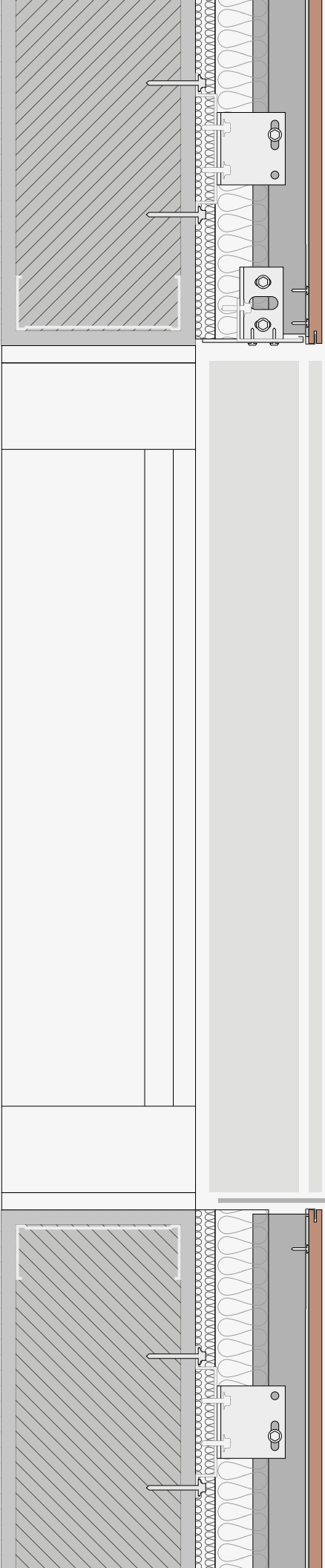
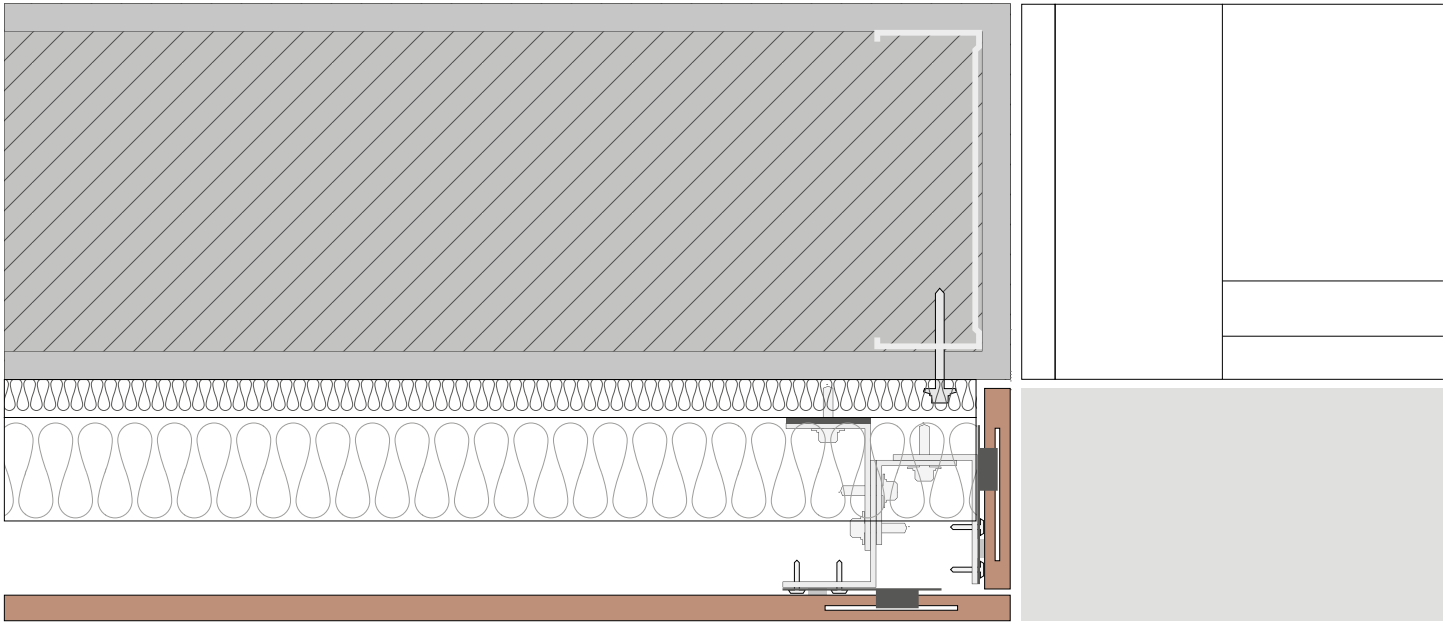

SKS / Single Kerf System

Horizontal Layout

Emphasize horizontality.
Clean lines, balanced proportions, and a calming rhythm through aligned porcelain panels.

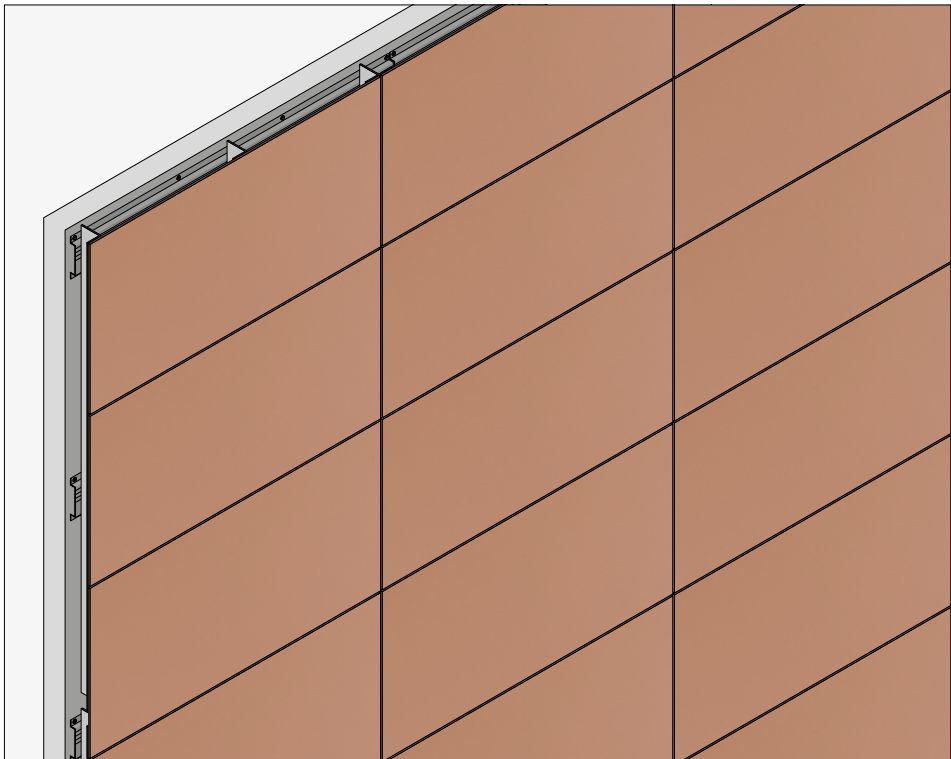

Vertical Layout

Emphasize verticality.
Emphasize verticality. Vertical lines that elevate the design, adding lightness and refined rhythm.

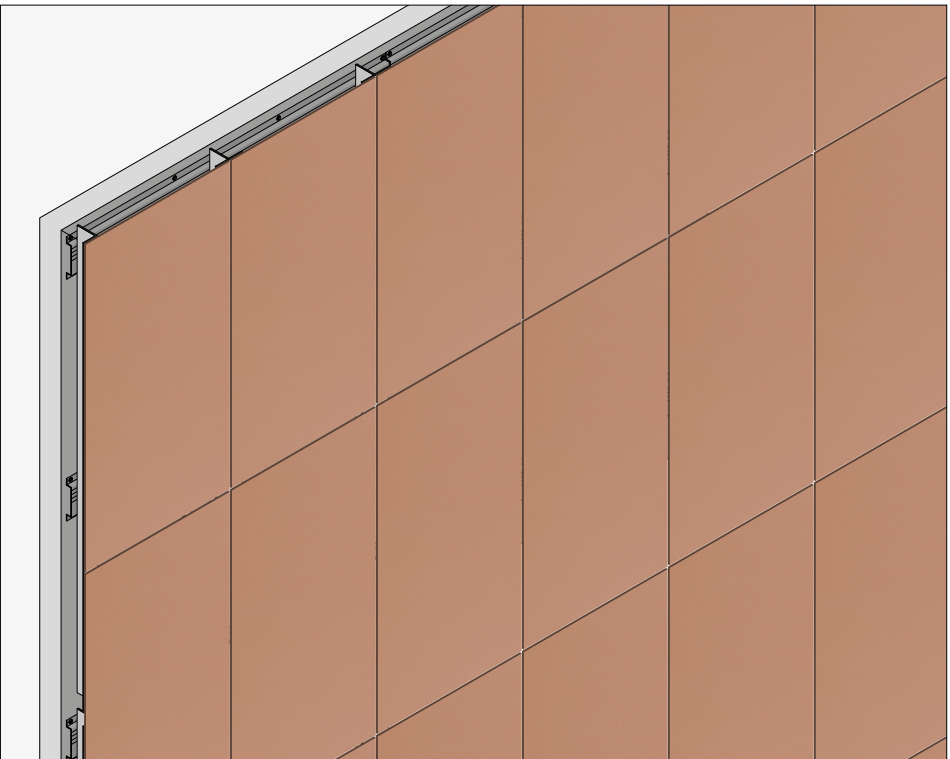

Staggered Layout

Emphasize movement.
Emphasize movement. Dynamic rhythm and visual flow with a modern, layered effect.

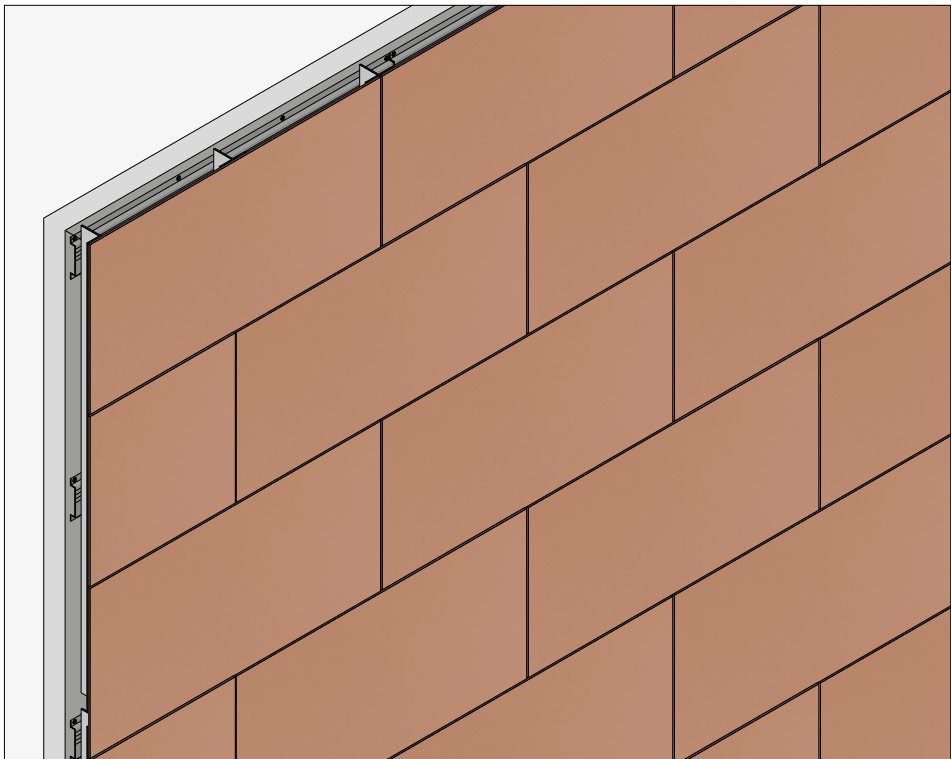

Mixed Layout

Emphasize joy and creativity.
Creative freedom through varied patterns and expressive rhythm.

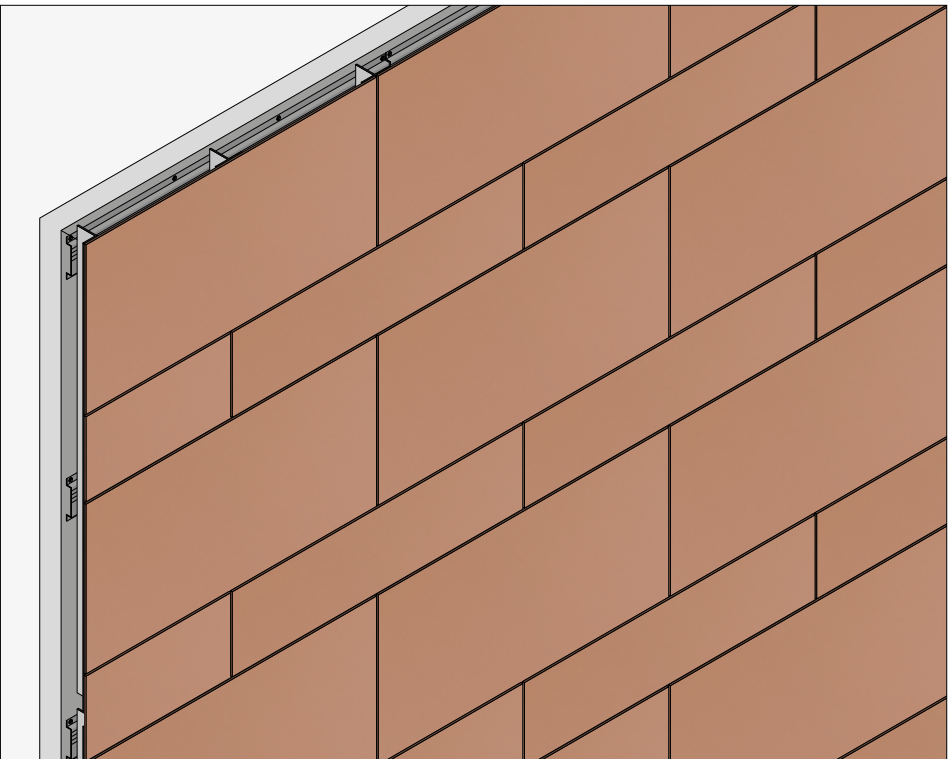



Get ahead to the
design curve!

CONTACT US AT

1.866.FACHADA

OR EMAIL US AT

hello@porcelanosafacades.
com

PORCELANOSA **FACADE/**