

PORCELANOSA FACADE/

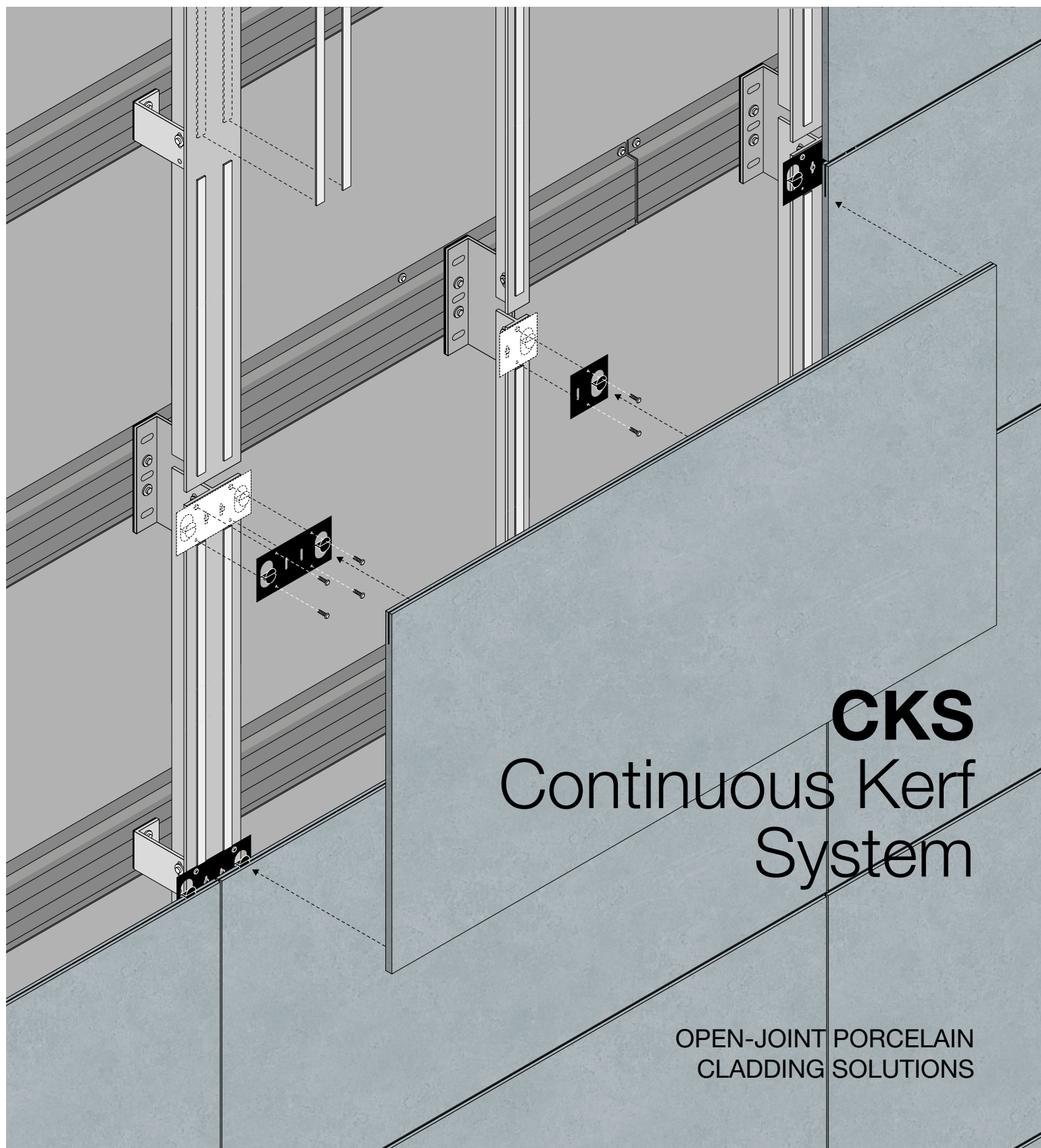

CKS
Continuous Kerf
System

OPEN-JOINT PORCELAIN
CLADDING SOLUTIONS

CKS / Continuous Kerf System

MAKE IT EASY BUILD BETTER

The CKS - Continuous Kerf System is a ventilated façade solution developed by Porcelanosa for pre-set size, landscape-oriented porcelain panels. This system streamlines the installation process and provides support for installers.

SECURE. PRECISE EFFORTLESS

CKS is a mechanical concealed fixing system that uses a discreet substructure and aluminum clips that anchor into cut continuous kerfs on the horizontal edges of Porcelanosa porcelain panels.

WHY CHOOSE CKS-CONTINUOUS KERF SYSTEM?

Thinking of Design
Backed by Porcelanosa Grupo, with a wide range of finishes to suit any architectural style. Enhances landscape-oriented layouts.

Concealed Fixing
Invisible mechanical clips provide a clean aesthetic and secure attachment.

Thermal & Acoustic Performance
Enhances insulation and energy efficiency.

Thermal & Acoustic Performance:
Enhances insulation and energy efficiency.

Durability
Engineered to endure, long lasting performance.

Fast Installation
Speed and simplicity on site. Efficiency without compromising quality.













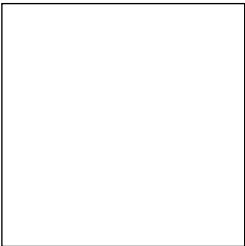
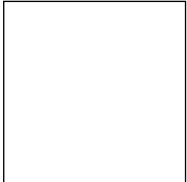
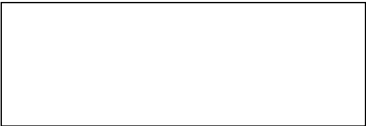

Design
your Porcelain
Program
+15,000 SF

CREATE A SIGNATURE LOOK FOR YOUR PROJECT

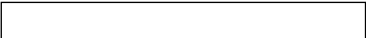
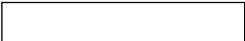
For façade designs exceeding **15,000 sf** in regular format panels, Porcelanosa offers the opportunity to co-design your own exclusive porcelain panels — a truly unique finish for landmark architecture. Bring your creative vision to life with personalized textures, tones, and dimensions.

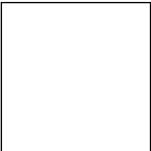
Panel Sizes Available

Regular Format PRE-SET SIZED MOLD TECHNOLOGY

 71" x 31"	 59" x 20"	 48" x 48"	 39" x 39"
 71" x 24"	 59" x 10"	 48" x 24"	 39" x 20"
 71" x 12"	 59" x 6"	 48" x 12"	
 71" x 8"		 48" x 8-6"	
 36" x 18"	 32" x 32"	 24" x 24"	
 36" x 9"	 32" x 16"		
 36" x 6"			

CKS / Continuous Kerf System

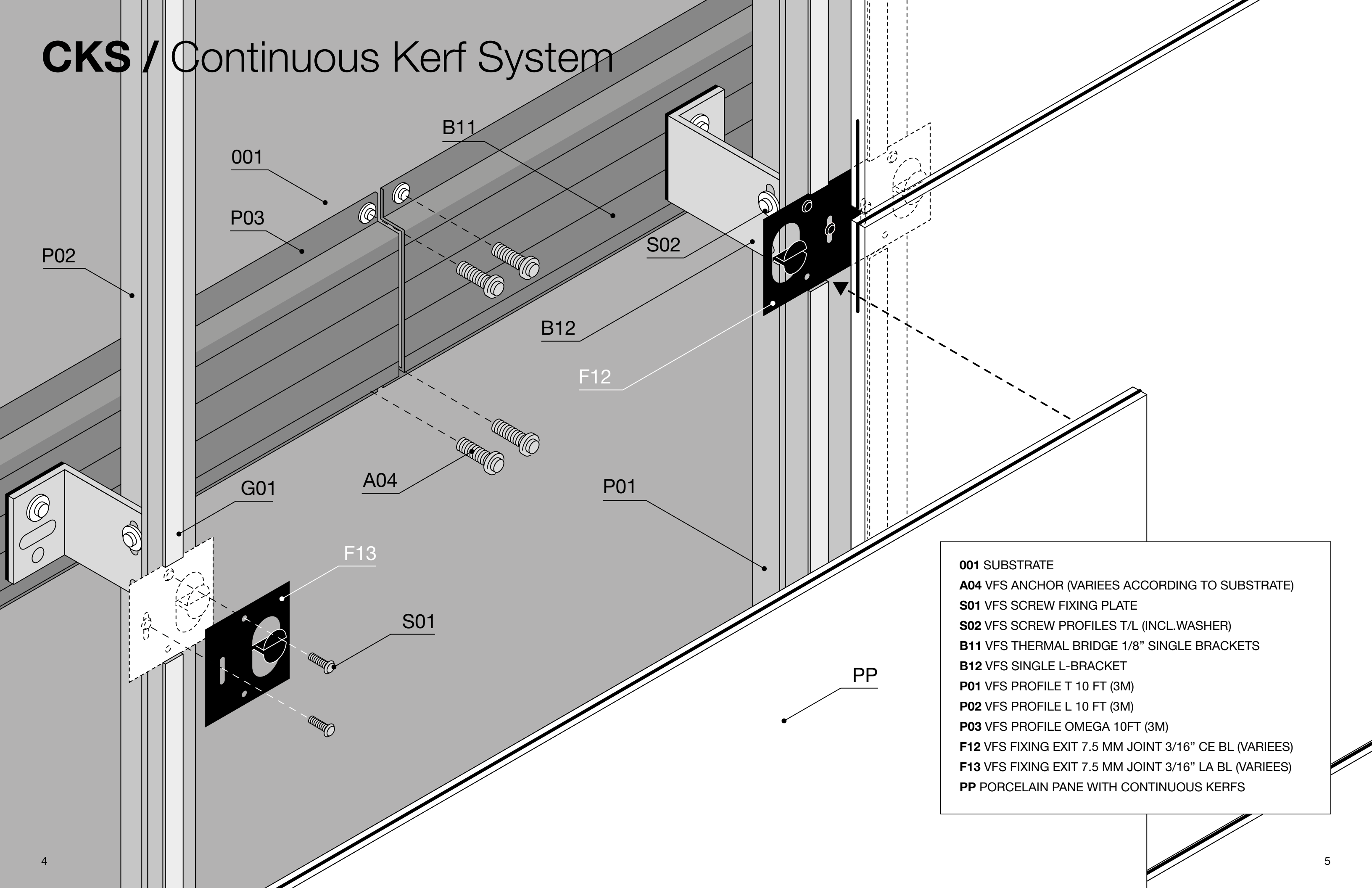

- 001** SUBSTRATE
- A04** VFS ANCHOR (VARIEES ACCORDING TO SUBSTRATE)
- S01** VFS SCREW FIXING PLATE
- S02** VFS SCREW PROFILES T/L (INCL.WASHER)
- B11** VFS THERMAL BRIDGE 1/8" SINGLE BRACKETS
- B12** VFS SINGLE L-BRACKET
- P01** VFS PROFILE T 10 FT (3M)
- P02** VFS PROFILE L 10 FT (3M)
- P03** VFS PROFILE OMEGA 10FT (3M)
- F12** VFS FIXING EXIT 7.5 MM JOINT 3/16" CE BL (VARIEES)
- F13** VFS FIXING EXIT 7.5 MM JOINT 3/16" LA BL (VARIEES)
- PP** PORCELAIN PANE WITH CONTINUOUS KERFS

CKS / Continuous Kerf System

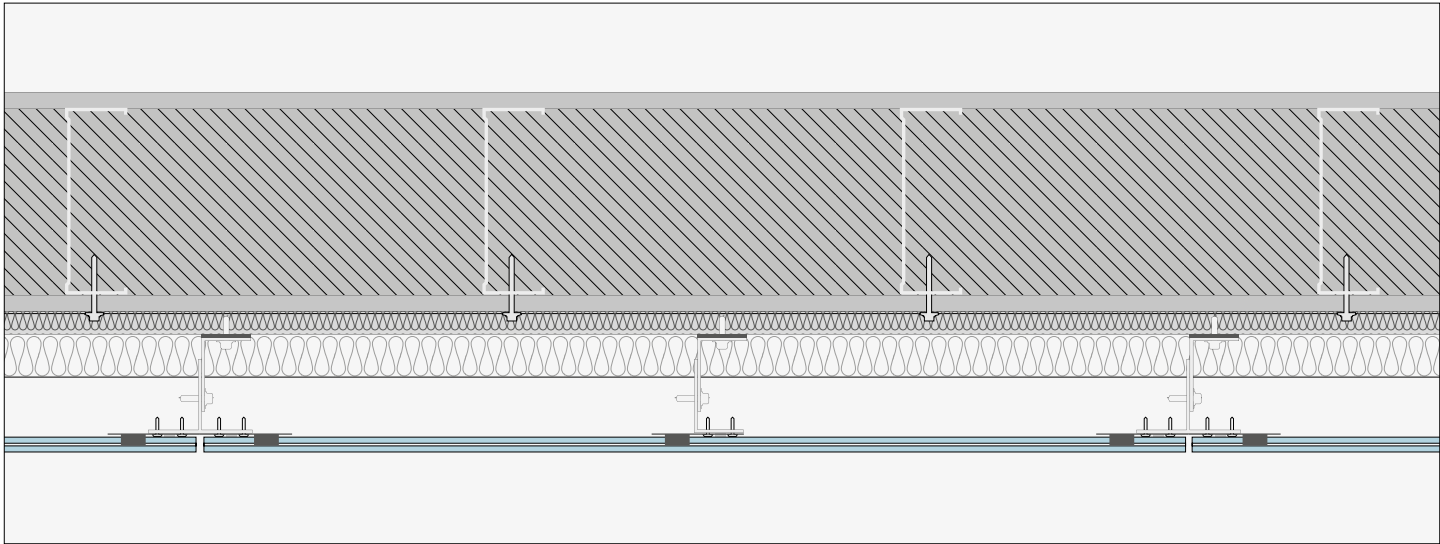

Horizontal Typical Detail.

SUBSTRUCTURE & BUILD-UP

The CKS system includes horizontal omegas, adjustable angle Brackets, vertical T-profiles, vertical L-profiles and fixing clips with different exits, in order to adapt to the required panel thickness.

This build-up forms a ventilated cavity between the panel and the structural wall, letting space for the exterior insulation and ensures continuous airflow behind the cladding.

Adjustable brackets:

Single and double brackets available with projections of 1-9/16" (40 mm), 2-3/8" (60mm), 3-1/8"(80mm), 3-15/16(100mm), 4-3/4"(120m), 5-1/2"(140mm), 6-5/16"(160 mm) and customizable projections to match thermal and design requirements.

Max./Min. build-up:

The façade projection is configurable. It has min. build-up of 3-3/4". The recommended/typical build-up is 4-1/2".

Recommended cavity:

Minimum 1" (25 mm) air gap between insulation and panel.

TOLERANCE IN/AND OUT

The system is designed to absorb surface irregularities in the substrate, offering up to 3/4" (20 mm) of in-and-out adjustability through the brackets.

Typical joints

- Standard vertical and horizontal joint: 3/16"(5 mmm) or 5/16" (8 mm)

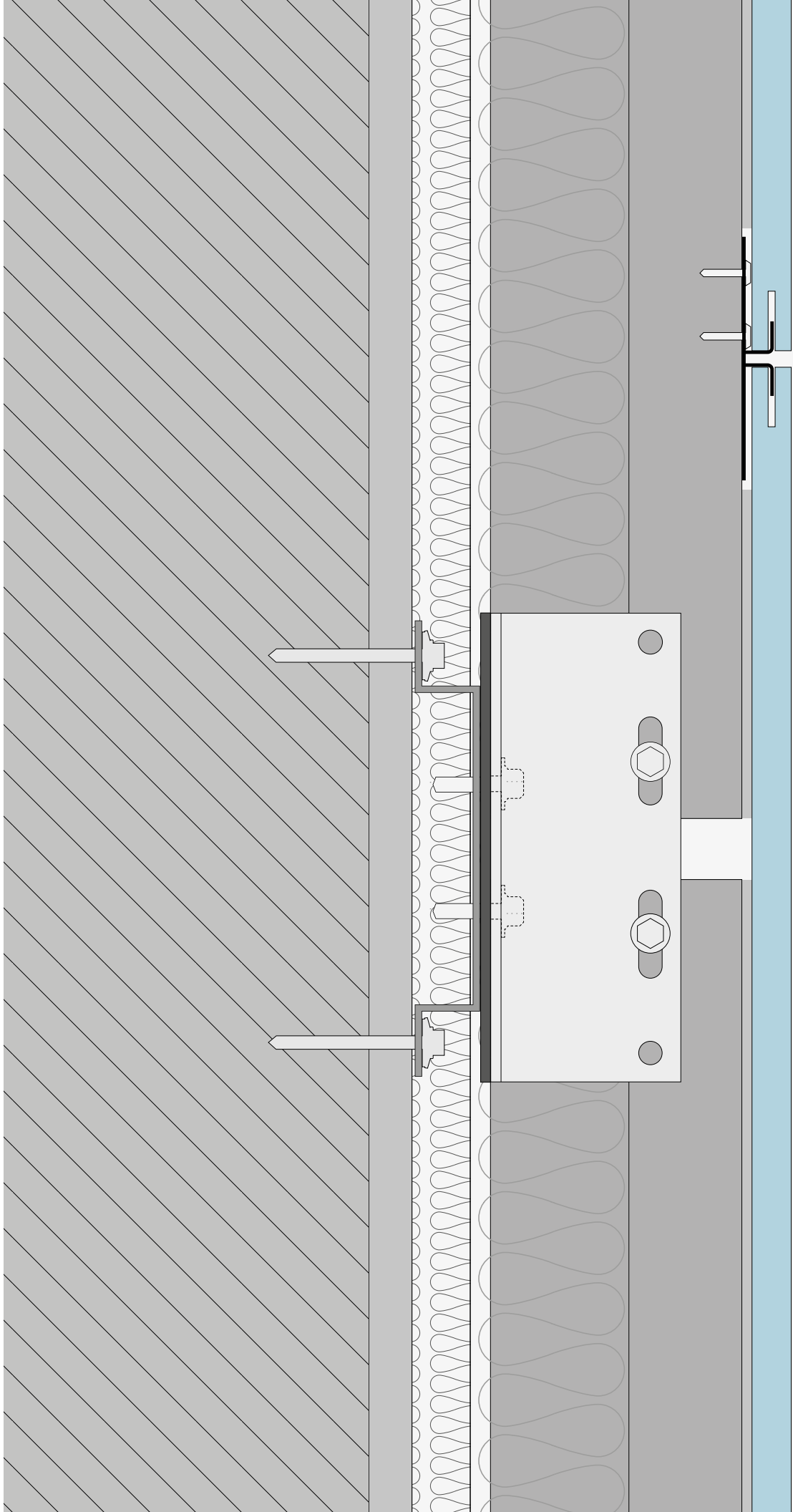

Vertical Typical Detail

CKS / Continuous Kerf System

1

Installation of horizontal omegas

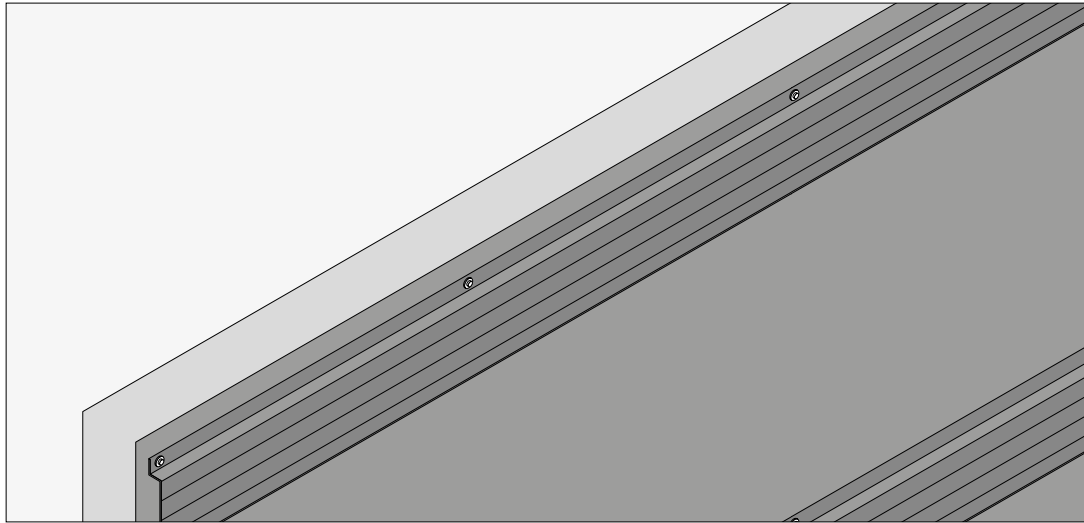

2

Installation of double and single brackets with its thermal breaks

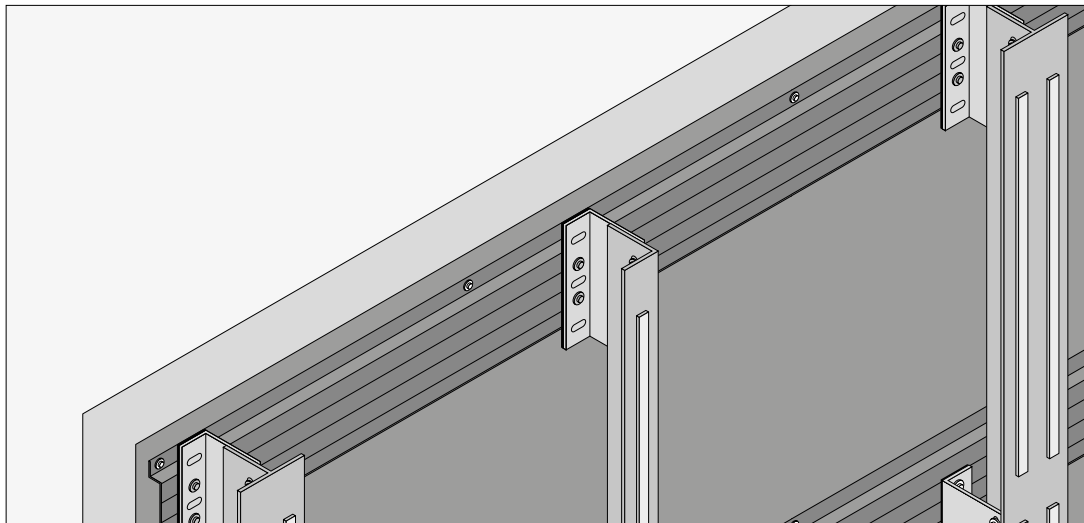

3

Installation of vertical L-profiles and placement of vertical T-profiles according to shop drawings provided by Porcelanosa. Installation of the fixing clips.

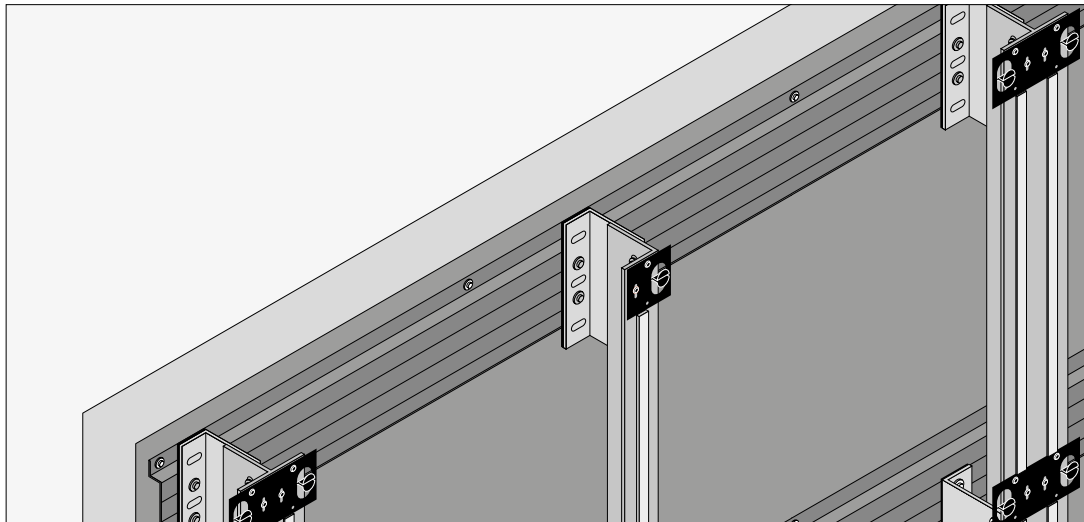

4

Placement of Porcelanosa porcelain panels according to façade layout

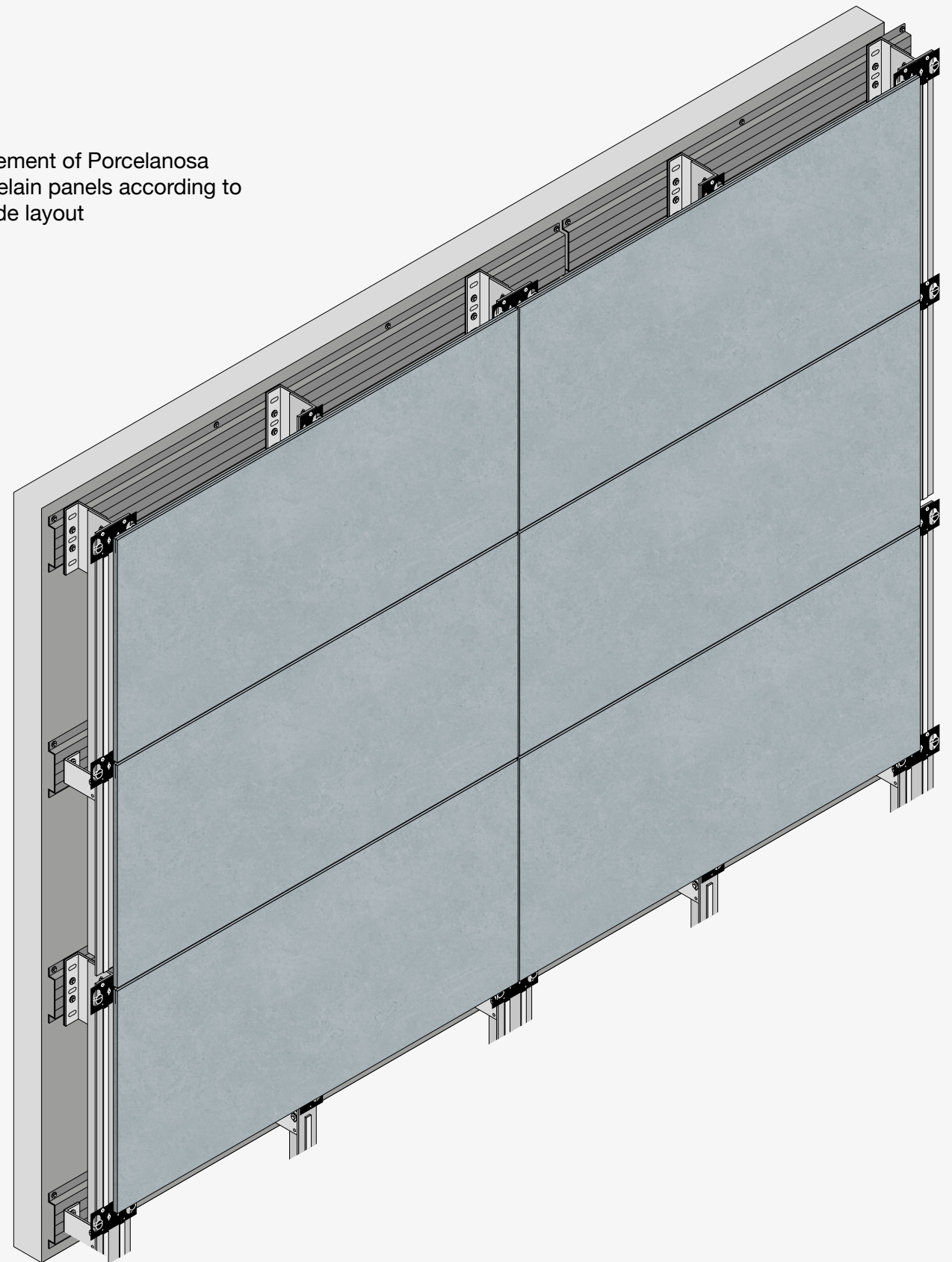

CKS / Continuous Kerf System

Every corner covered —

Technical details specifically designed to adapt to all façade situations.

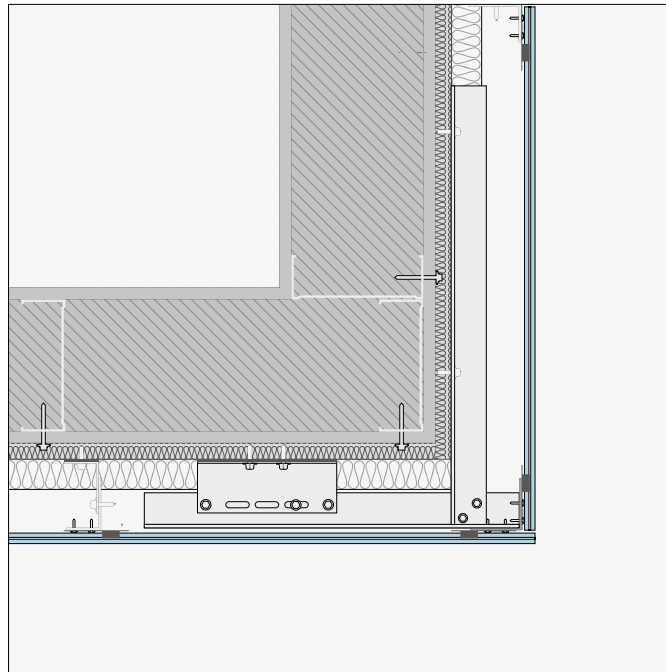

Outside Corner Detail

Total resolution of the façade —

Complete façade integration, edge to edge

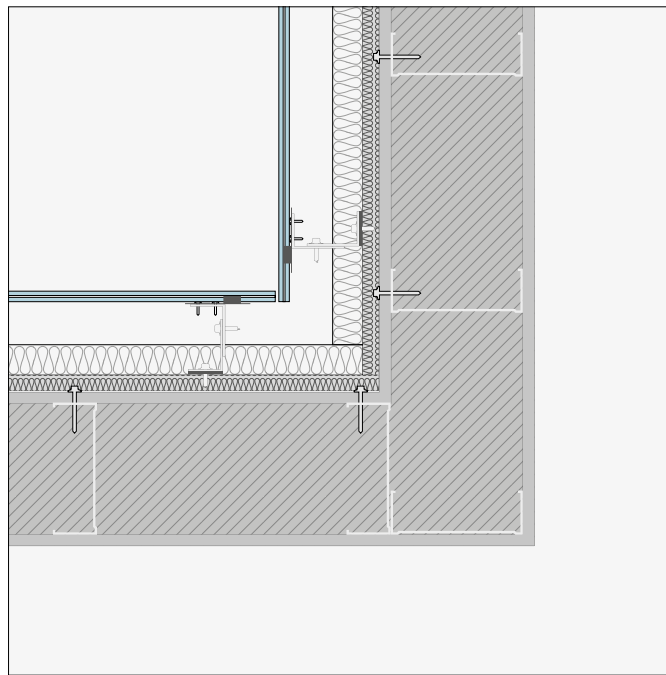

Inner Corner Detail

Type of Corners

Play and design with our different type of corners. Choose elegant solutions with the typical corner, mitered corners and recessed corners.

Recessed corners are ideal for seismic zones.

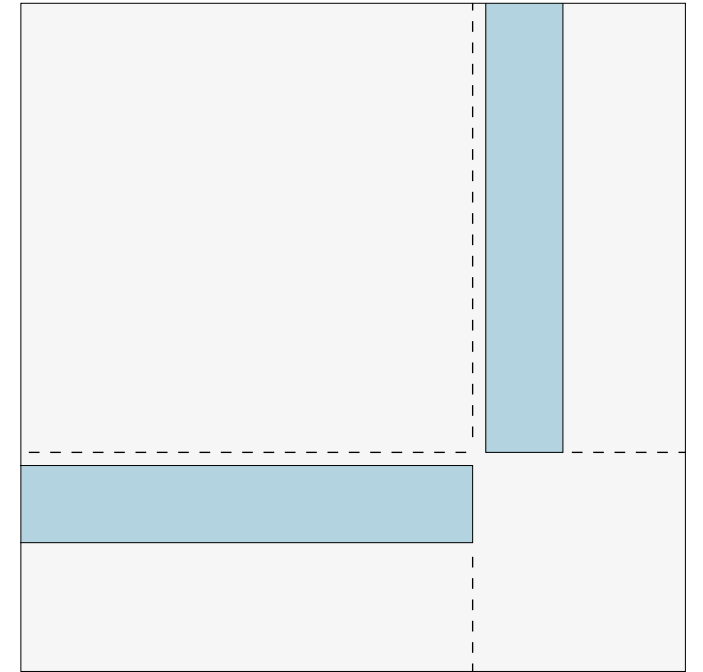

Recessed Corner

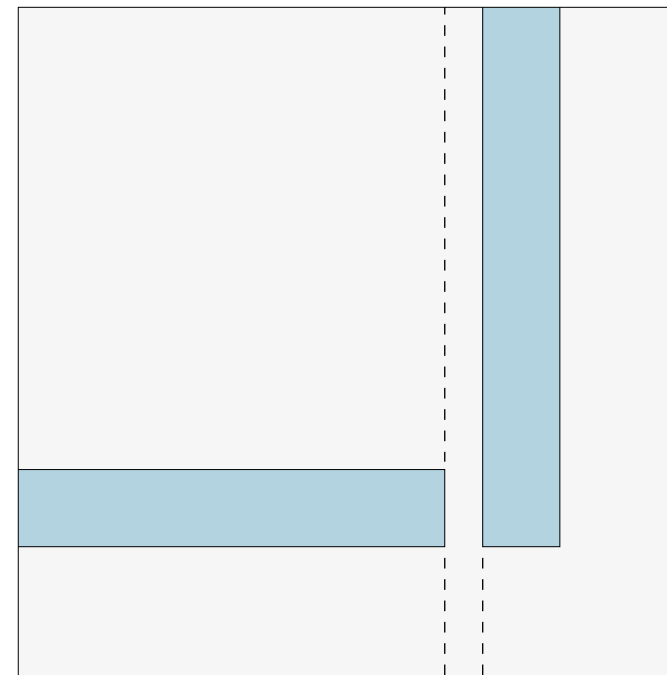

Typical Corner

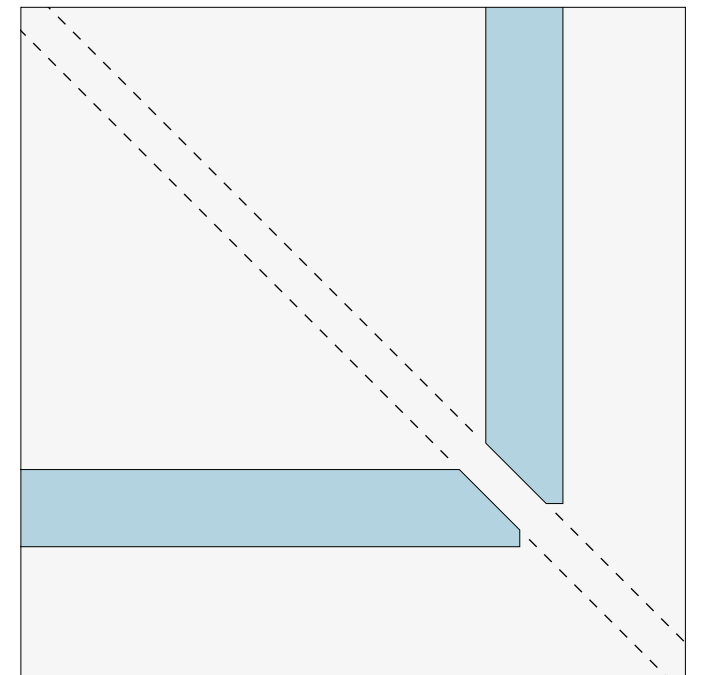

Mitered Corner

CKS / Continuous Kerf System

Opening Solutions

Clad all your vertical returns and horizontal heads of all the openings of your project with our solutions. Take into account min. width returns of 3-5/8".

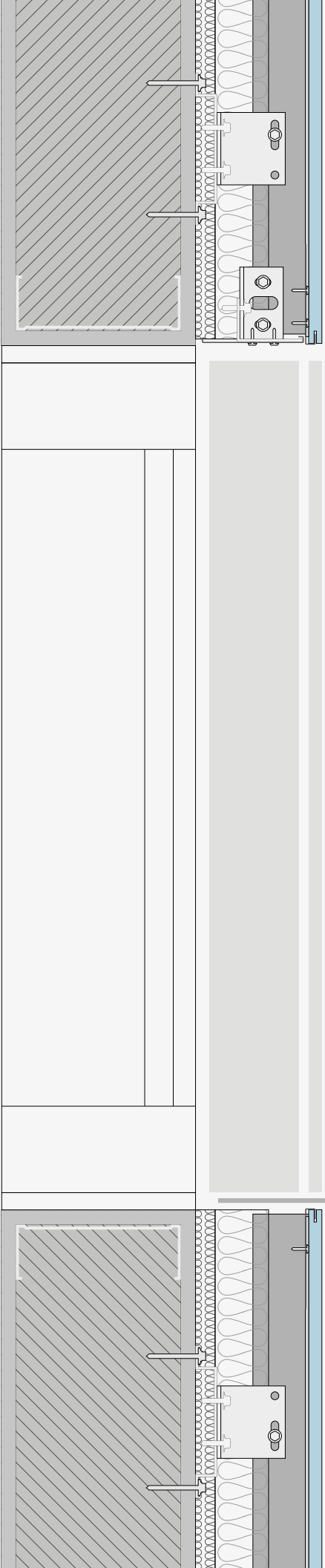
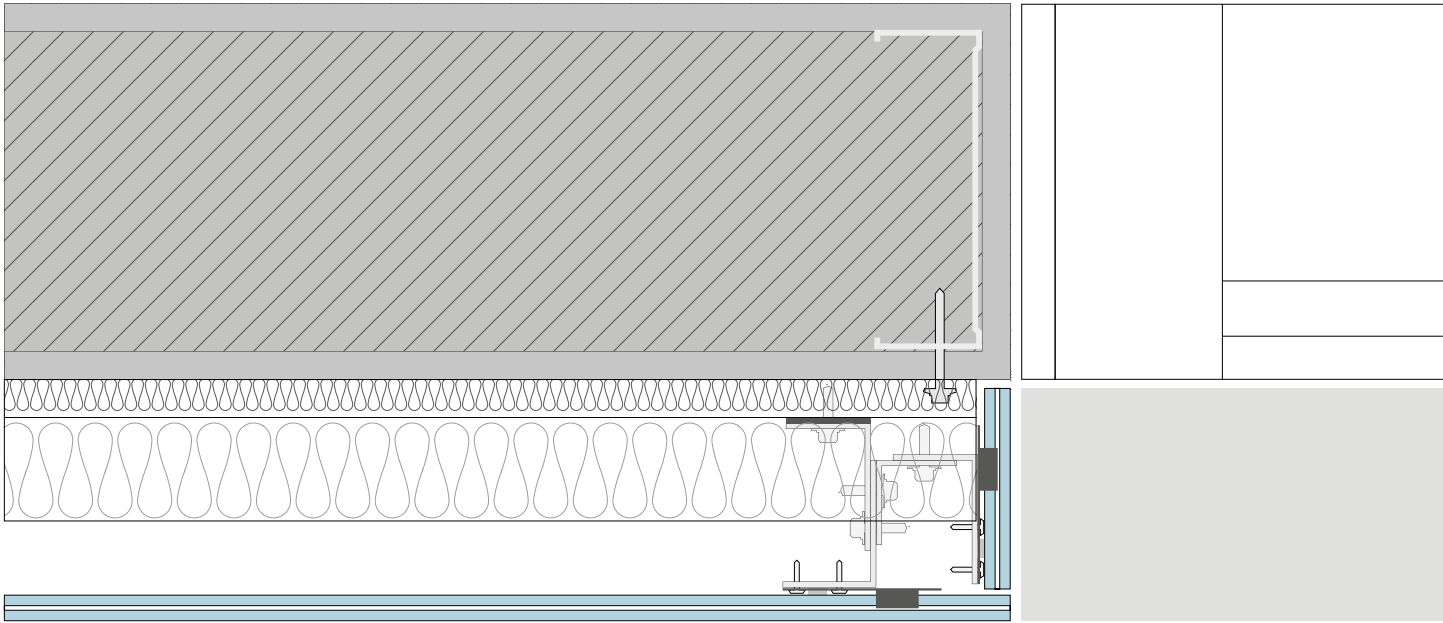

CKS / Continuous Kerf System

Optimized for Landscape Layouts

The CKS system is specifically designed to support landscape-oriented panel configurations. Its structure simplifies execution and enhances alignment, making it the ideal choice for achieving sleek, horizontal design lines with precision and efficiency.

Staggered Layout

Create visual interest and modern energy with a staggered, rhythmic composition.

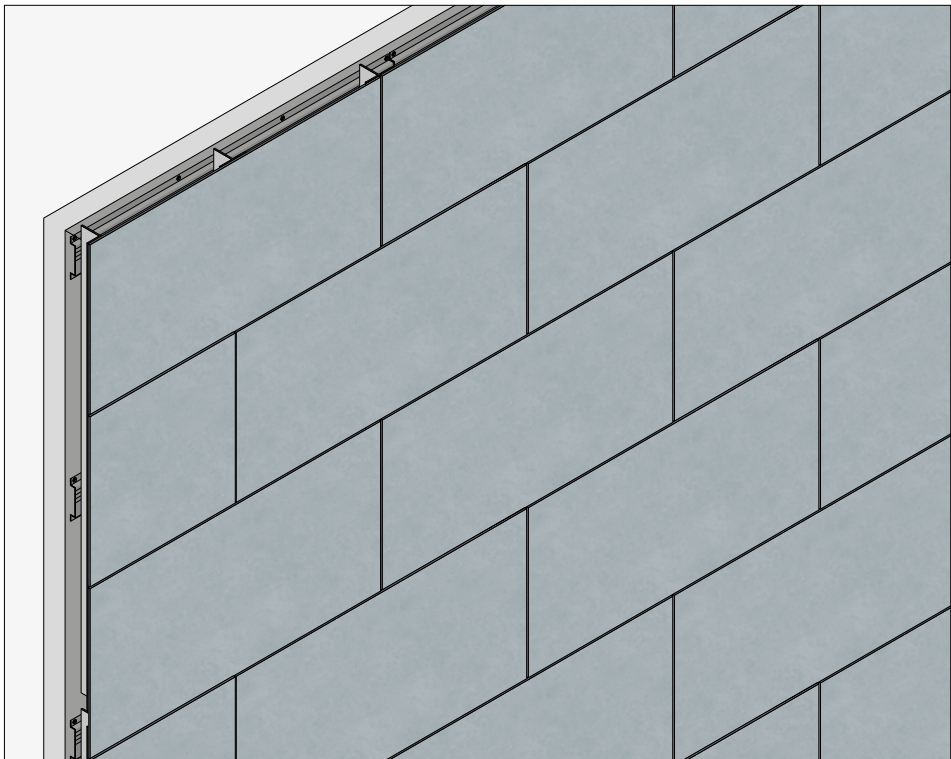

Horizontal Layout

A serene visual rhythm through perfectly aligned porcelain panels.

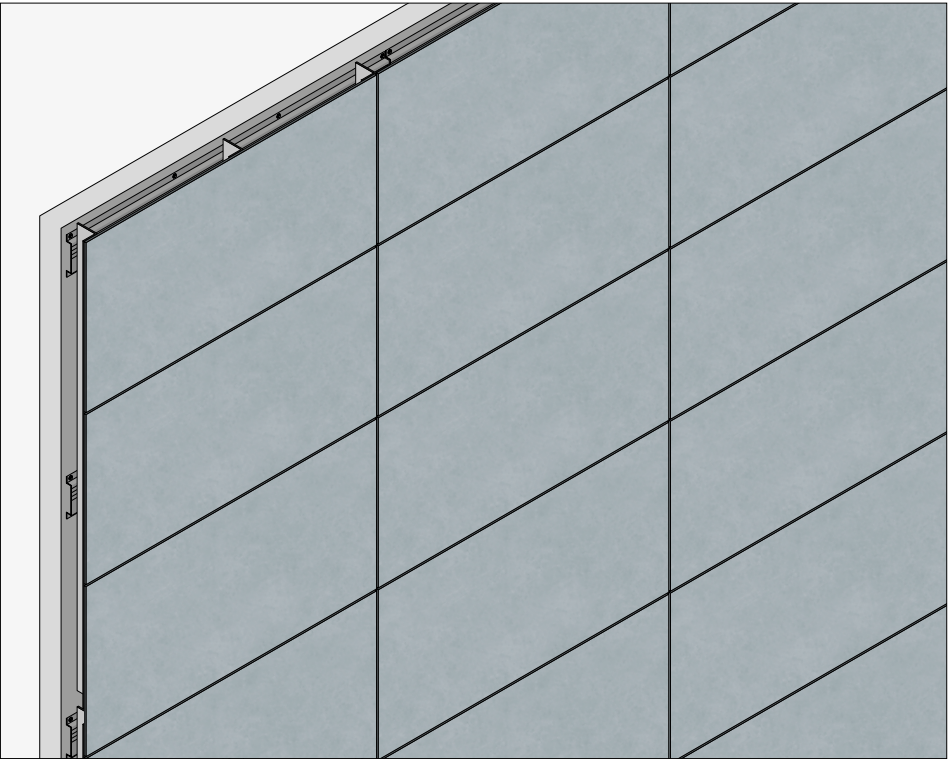

Mixed Layout

Highlight creativity and expression with freedom of design.

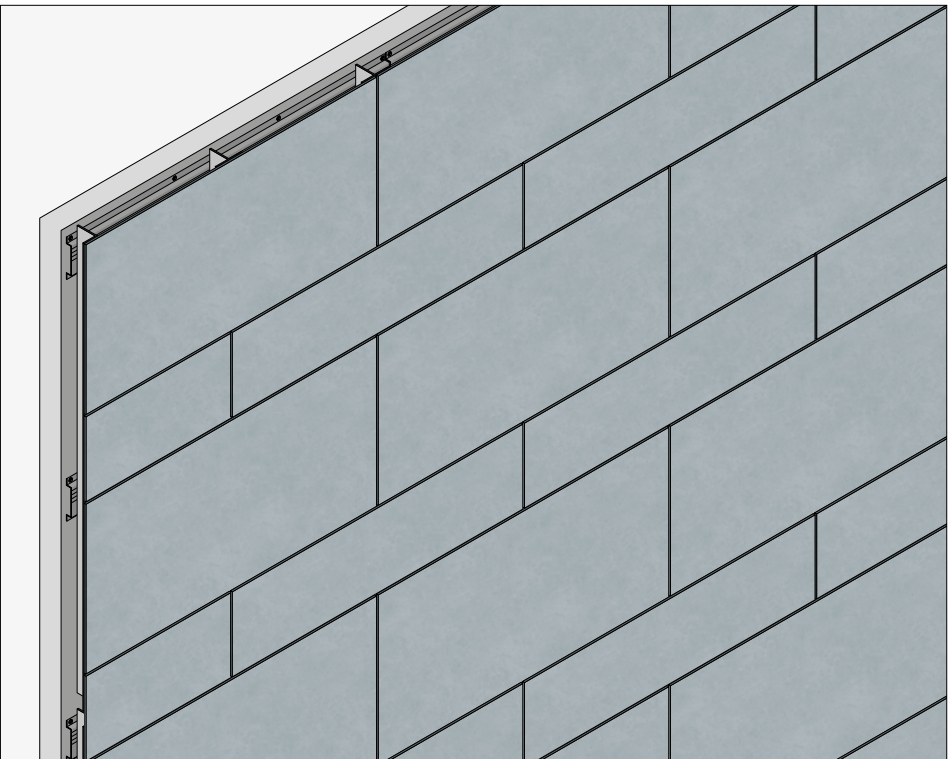



Get ahead to the
design curve!

CONTACT US AT

1.866.FACHADA

OR EMAIL US AT

hello@porcelanosafacades.
com

PORCELANOSA **FACADE/**