

# PORCELANOSA FACADE/

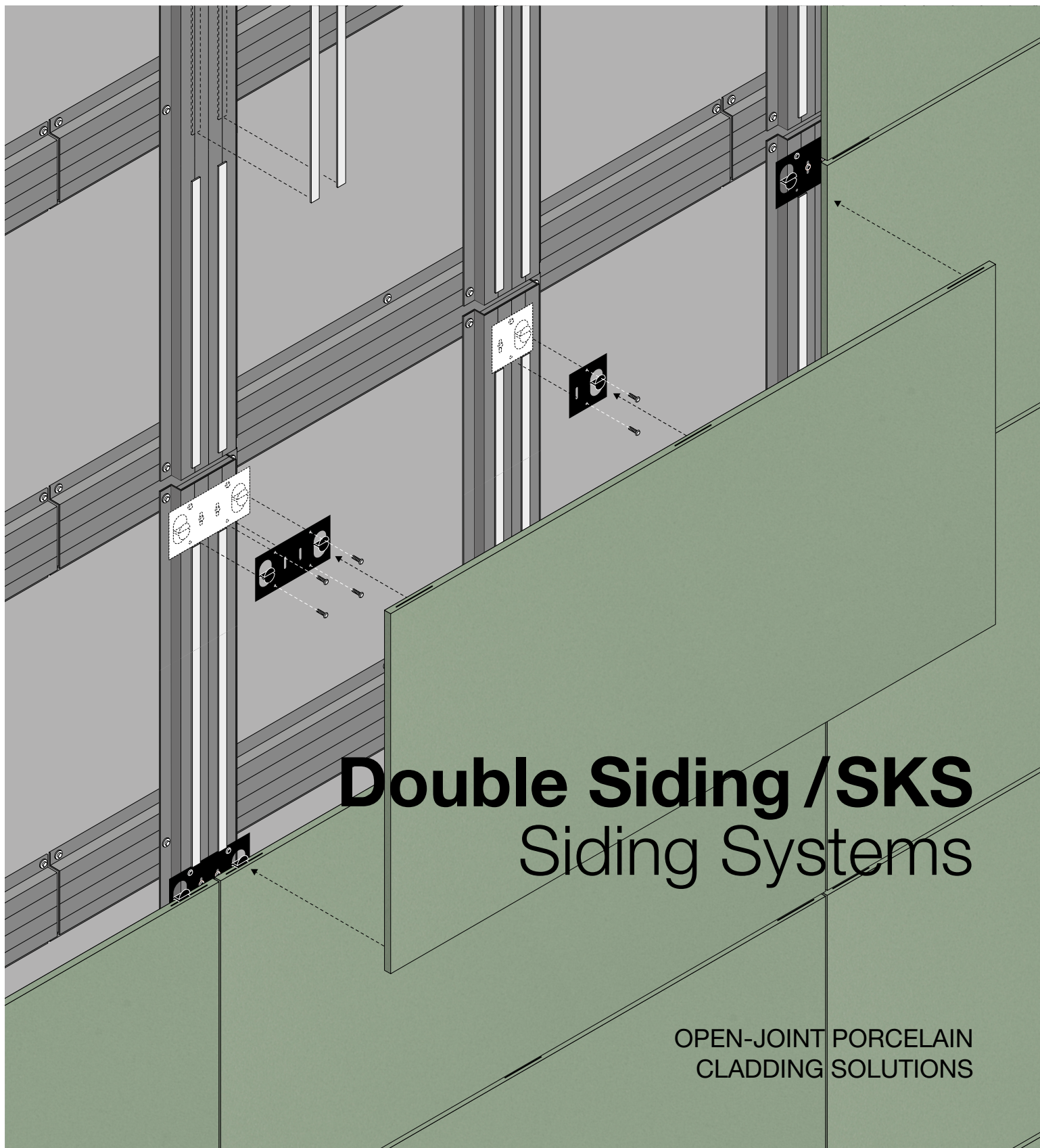

## Double Siding / SKS Siding Systems

OPEN-JOINT PORCELAIN  
CLADDING SOLUTIONS

# Double Siding /SKS Siding Systems

## DESIGN YOUR VIEW BUILT YOUR DREAMS

The Siding Systems are a façade solution developed by Porcelanosa for pre-set size porcelain cladding panels designed to reduce the build-up of the constructive section detail. The DS – Double Siding System + SKS – Single Kerf System offer a wide range of layouts for architects and design teams.

## A SIMPLE SYSTEM A GREAT FAÇADE

DS/SKS is mechanical-adhesive concealed fixing system that uses the minimal possible substructure to reduce the build-up; The porcelain panels of Porcelanosa are supported to the substructure through clips that are anchored into cut single kerfs on their edges.

The System allows the façade to work without external thermal insulation; But it also offers a solution with solid continuous insulation to get to the needs of each project.

### Design your Porcelain Program +15,000 SF

### CREATE A SIGNATURE LOOK FOR YOUR PROJECT

For façade designs exceeding **15,000 sf** in regular format panels, Porcelanosa offers the opportunity to co-design your own exclusive porcelain panels — a truly unique finish for landmark architecture. Bring your creative vision to life with personalized textures, tones, and dimensions.

## WHY CHOOSE DS/SKS SYSTEM?

**Unlimited Designs**  
Porcelanosa Grupo offer an unlimited of porcelain finishes.

**Simplicity**  
The simplicity of the system allows reduced build-up, as well as quick installation.













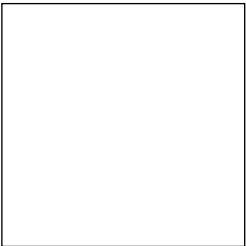
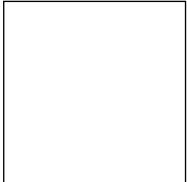
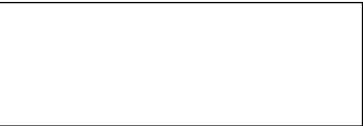

**Concealed Fixing**  
Invisible mechanical clips and the construction adhesive by Porcelanosa ensures a clean façade.

**Thermal Performance**  
The system lets the architects work with or without external insulation, and even better, the option of having continuous external insulation.

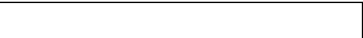
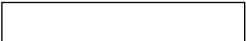
**Durability**  
Ensures a resilient solution for modern building envelopes.

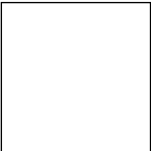
# Panel Sizes Available

## Regular Format PRE-SET SIZED MOLD TECHNOLOGY

 71" x 31"	 59" x 20"	 48" x 48"	 39" x 39"
 71" x 24"	 59" x 10"		
	 59" x 6"	 48" x 24"	 39" x 20"
 71" x 12"		 48" x 12"	
 71" x 8"		 48" x 8-6"	
 36" x 18"	 32" x 32"	 24" x 24"	
 36" x 9"			
 36" x 6"	 32" x 16"		

# Double Siding /SKS

## Siding Systems

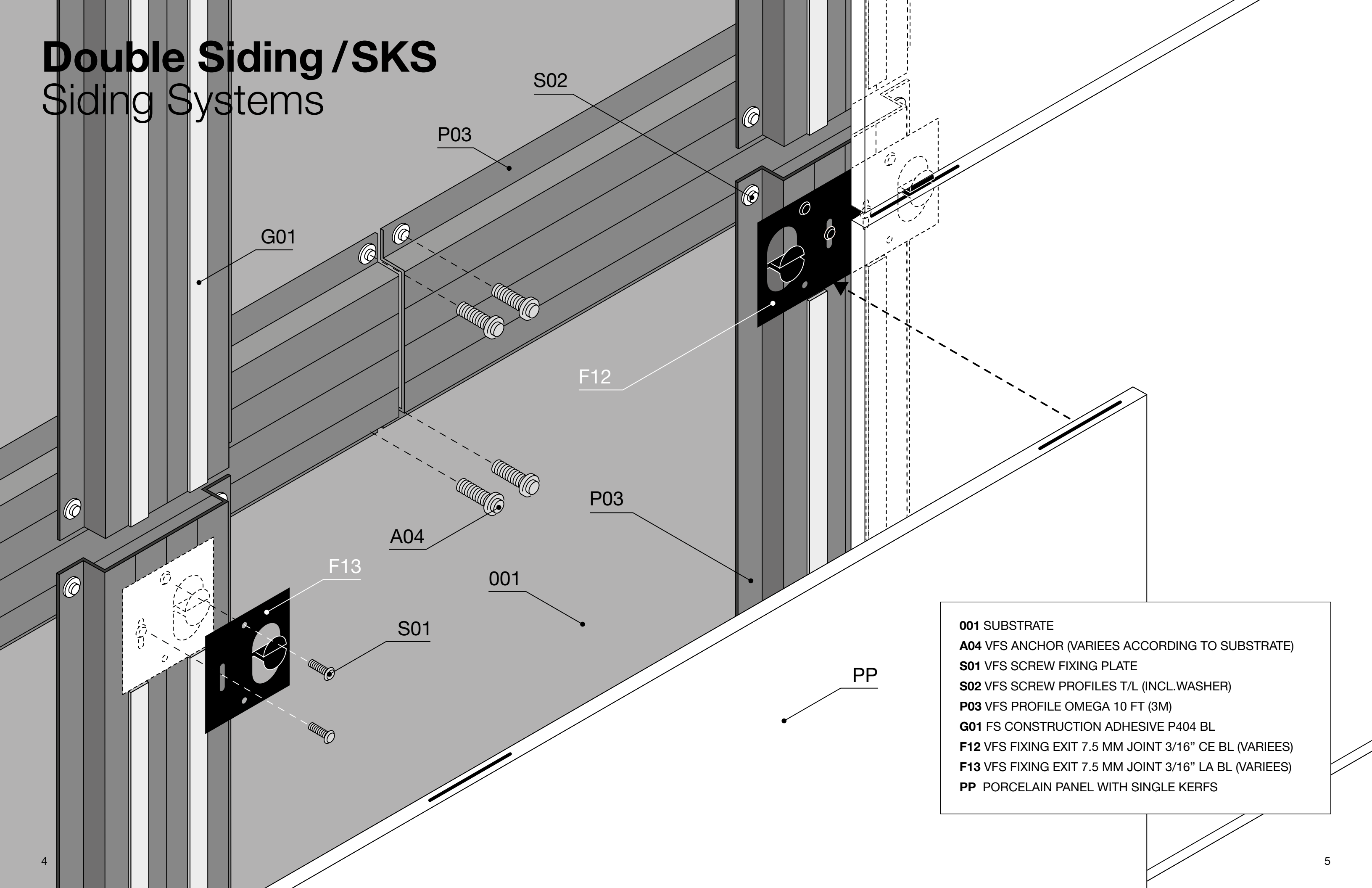

- 001** SUBSTRATE
- A04** VFS ANCHOR (VARIEES ACCORDING TO SUBSTRATE)
- S01** VFS SCREW FIXING PLATE
- S02** VFS SCREW PROFILES T/L (INCL.WASHER)
- P03** VFS PROFILE OMEGA 10 FT (3M)
- G01** FS CONSTRUCTION ADHESIVE P404 BL
- F12** VFS FIXING EXIT 7.5 MM JOINT 3/16" CE BL (VARIEES)
- F13** VFS FIXING EXIT 7.5 MM JOINT 3/16" LA BL (VARIEES)
- PP** PORCELAIN PANEL WITH SINGLE KERFS

# Double Siding /SKS

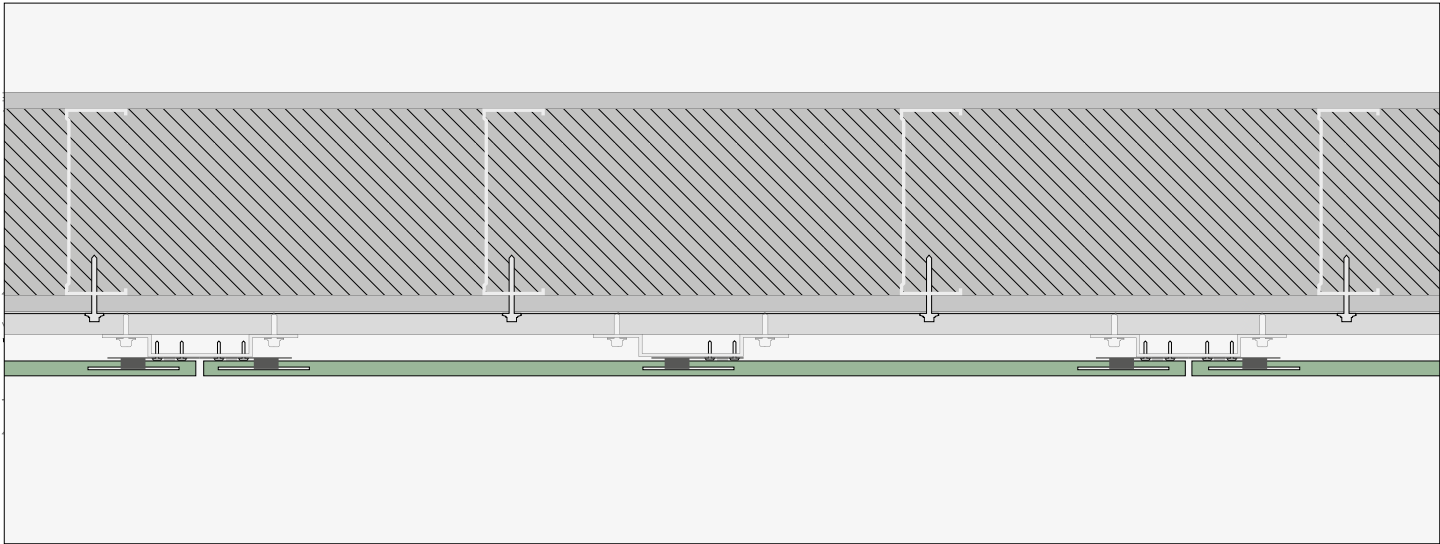

Horizontal Typical Detail.

## SUBSTRUCTURE & BUILD-UP

The DS/SKS system includes horizontal, vertical omegas and fixing clips with different exits, in order to adapt to the required panel thickness. The build-up, and there for the ventilated cavity between the porcelain and the substrate is reduced.

### Max./Min. build-up:

The façade projection is always the same for configurations without solid continuous insulation. It has a build-up of 2-1/4".

In the case of a solid continuous insulation desired, the build-up grows the thickness of the insulation.

### Typical joints:

Standard vertical and horizontal joint: 3/16" (5 mmm) or 5/16" (8 mm)

## SOLID CONTINUOS INSULATION SOLUTION

The system offers a solution with continuous insulation on the outside of the substrate. It can be supported on solid insulation and anchored directly to the substrate through it with only punctual fixings; to reduce the thermal bridges and enhancing the thermal performance.

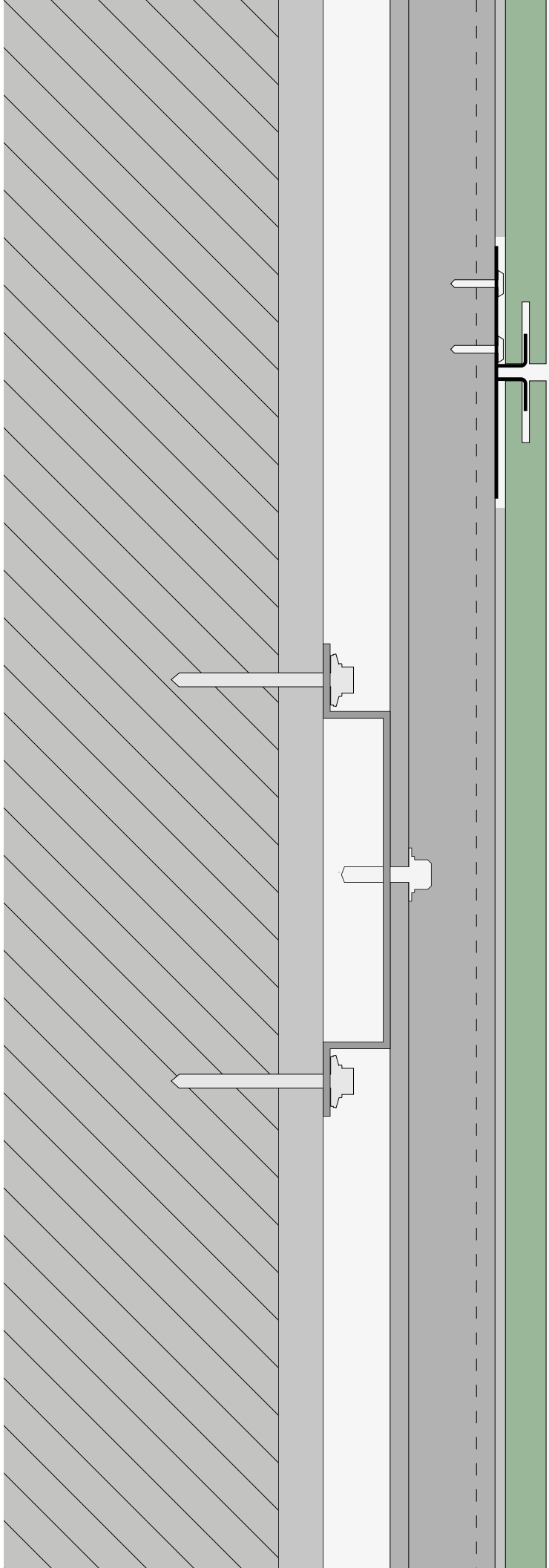
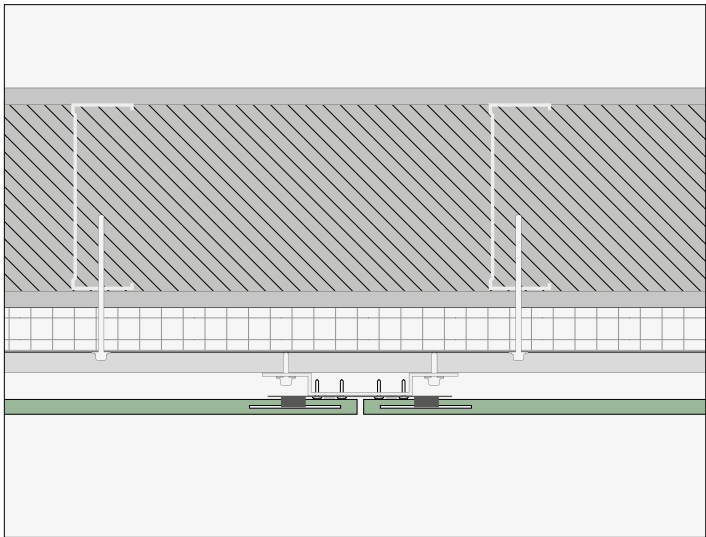

Vertical Typical Detail

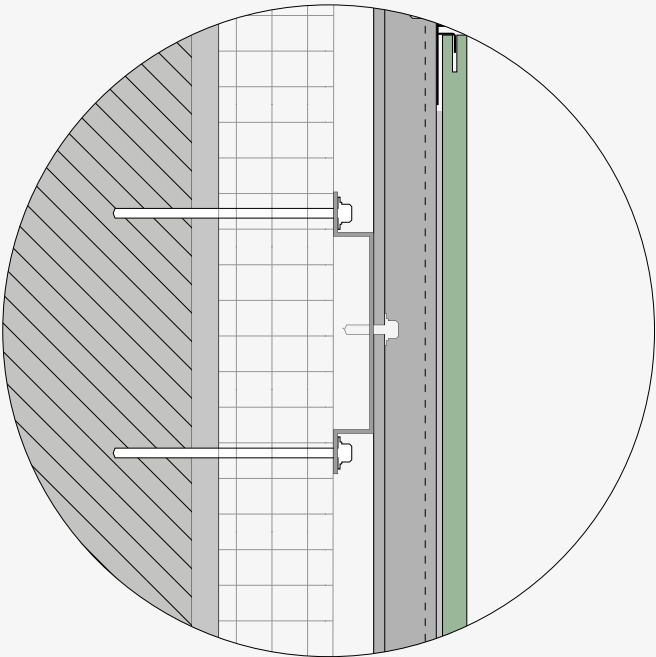



# Double Siding /SKS

1

Installation of horizontal  
omegas

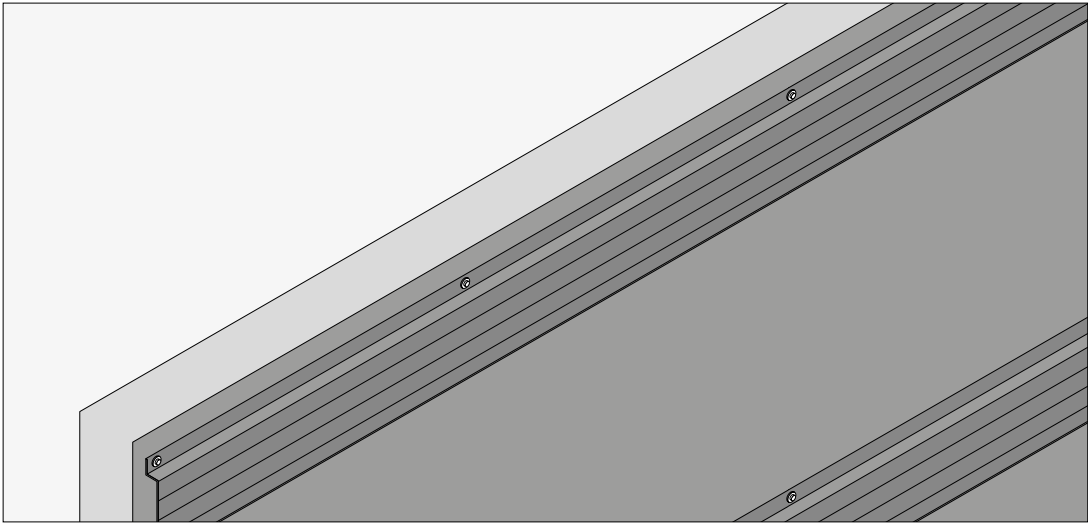

2

Installation of vertical  
omegas aligned with  
the position of the  
required single kerfs in  
the panels.

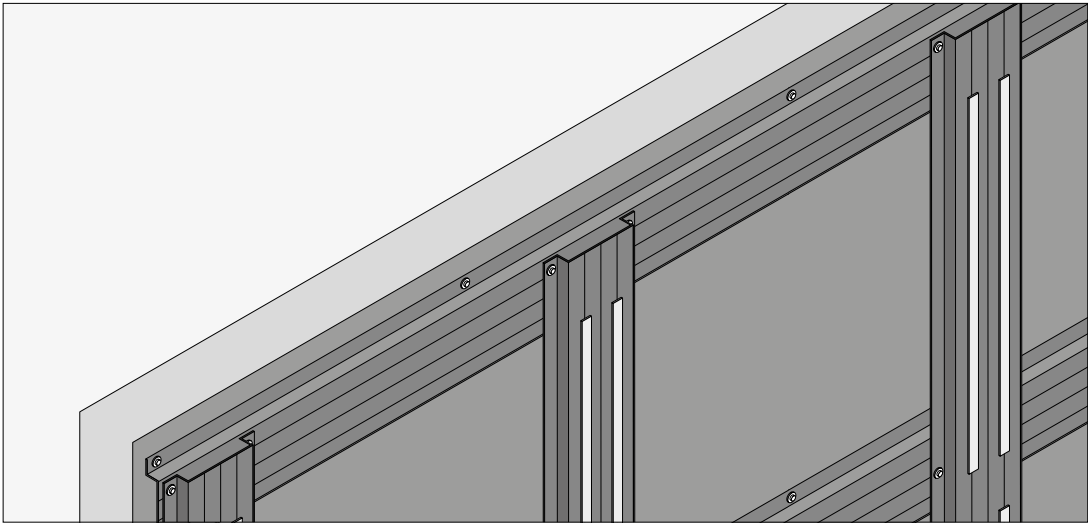

3

Installation of the first  
clips/fixings

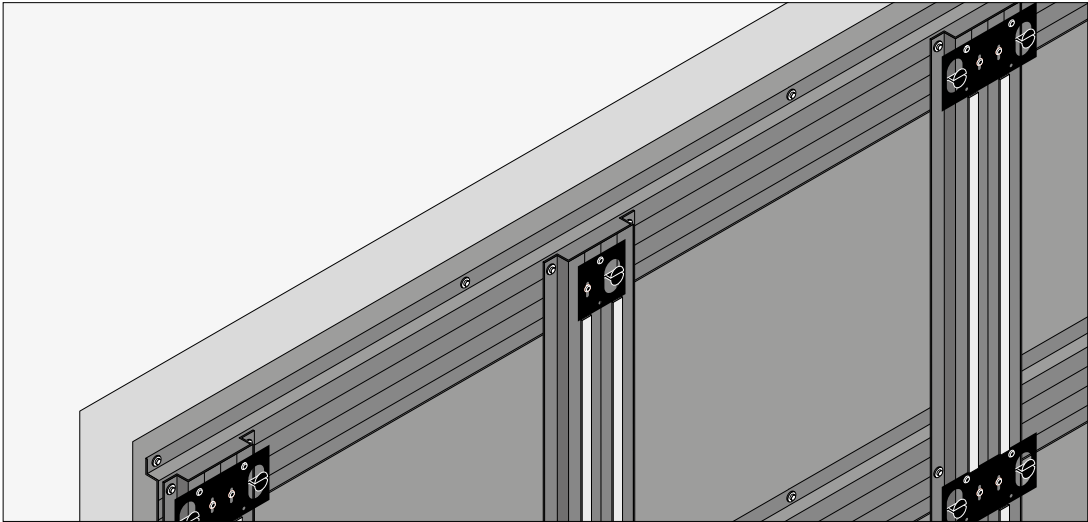

4

Installation of the porcelain panels  
according to façade layout

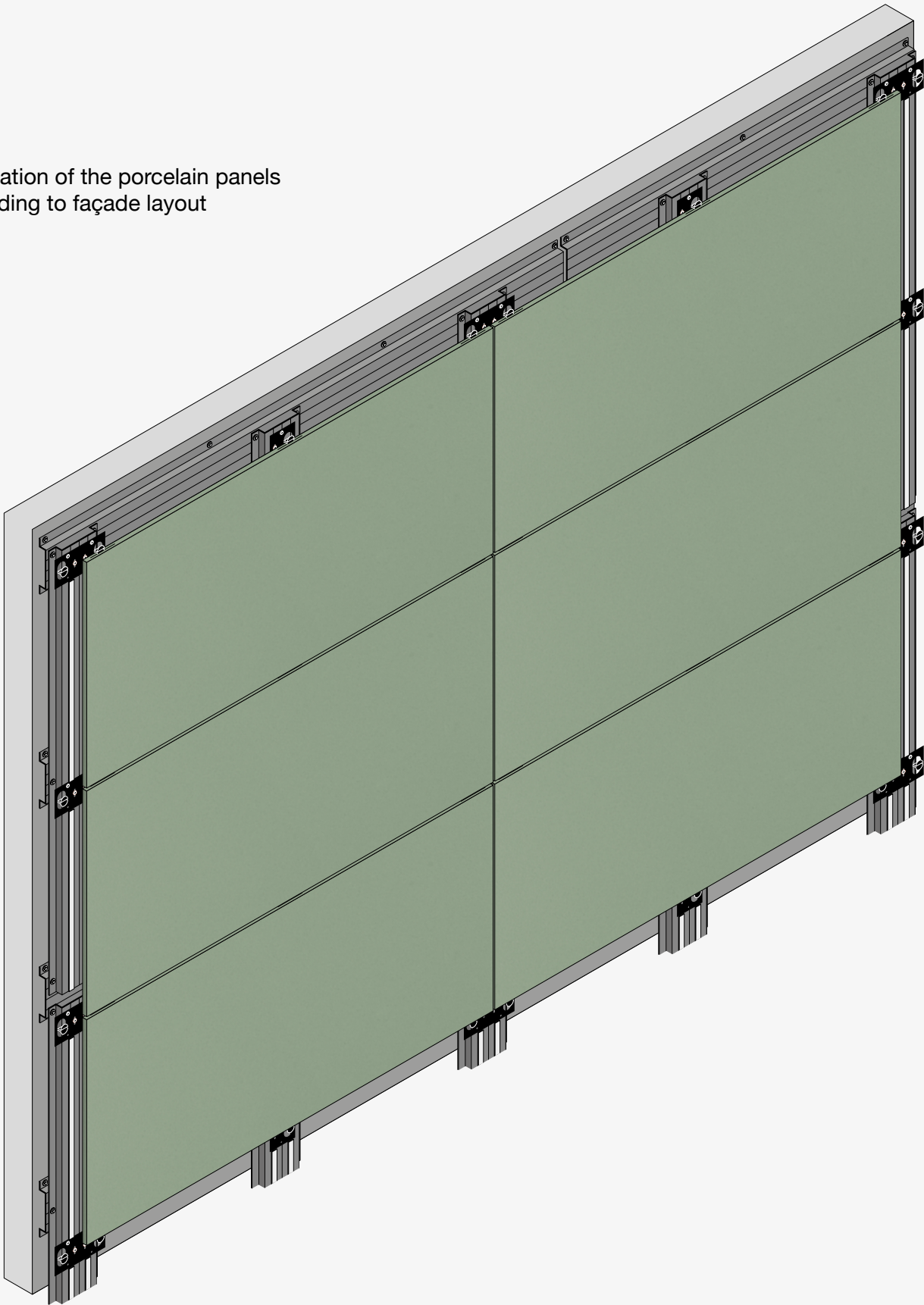

# Double Siding /SKS

**All details thought —**  
Technical solutions for  
external corners

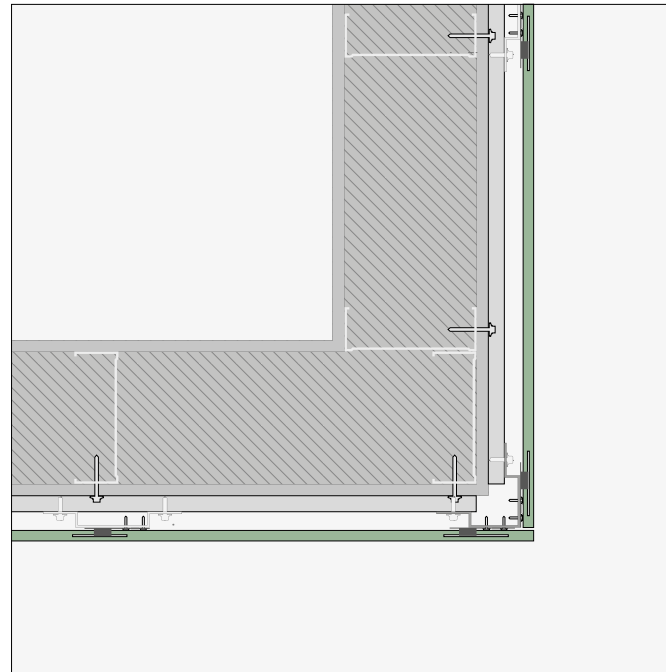

Outside Corner Detail

**All façades encounters  
resolved —**  
Technical solutions for  
internal corners

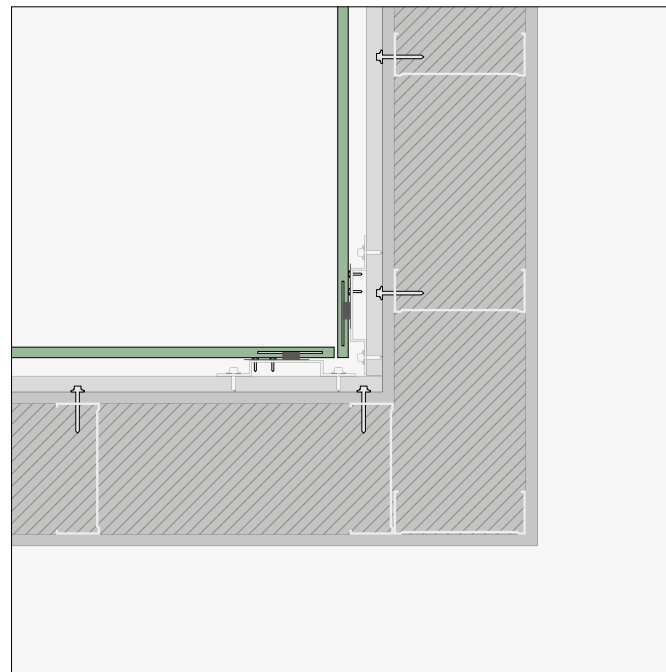

Inner Corner Detail

## Type of Corners

Play and design with our different type of corners. Choose elegant solutions with the typical corner, mitered corners and recessed corners.

Recessed corners are ideal for seismic zones.

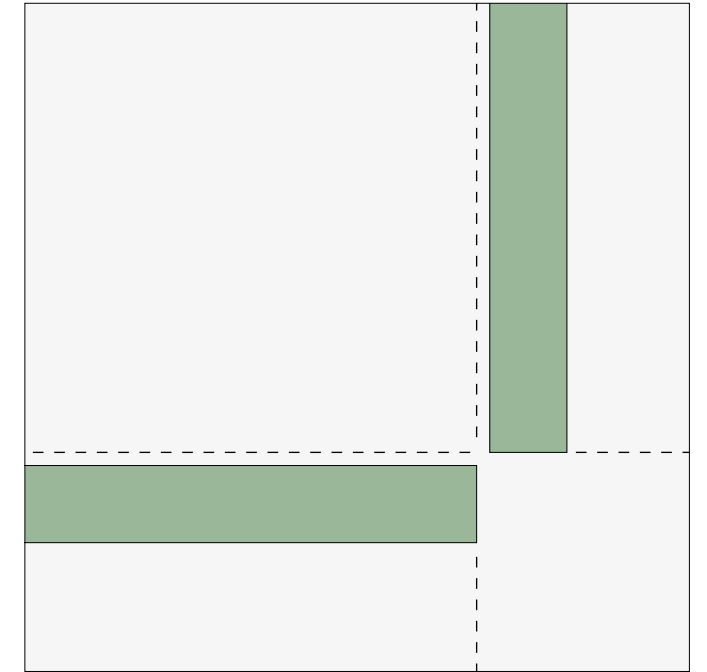

Recessed Corner

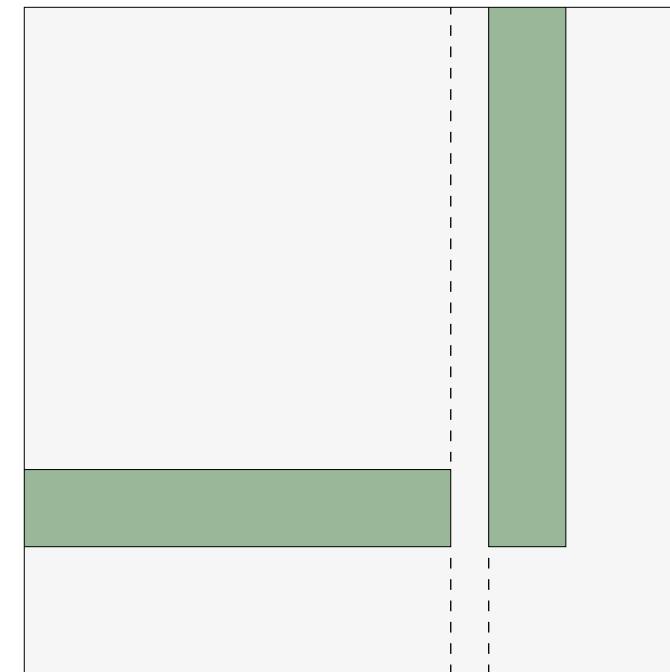

Typical Corner

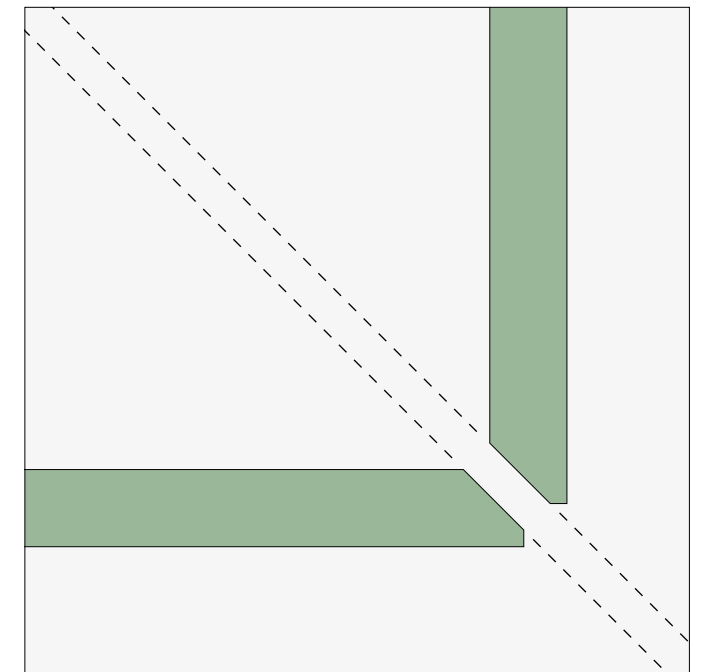

Mitered Corner

# Double Siding /SKS

## Siding Systems

### Opening Solutions

Combine in your project our façade with all kind of window frames. Create unique designs.

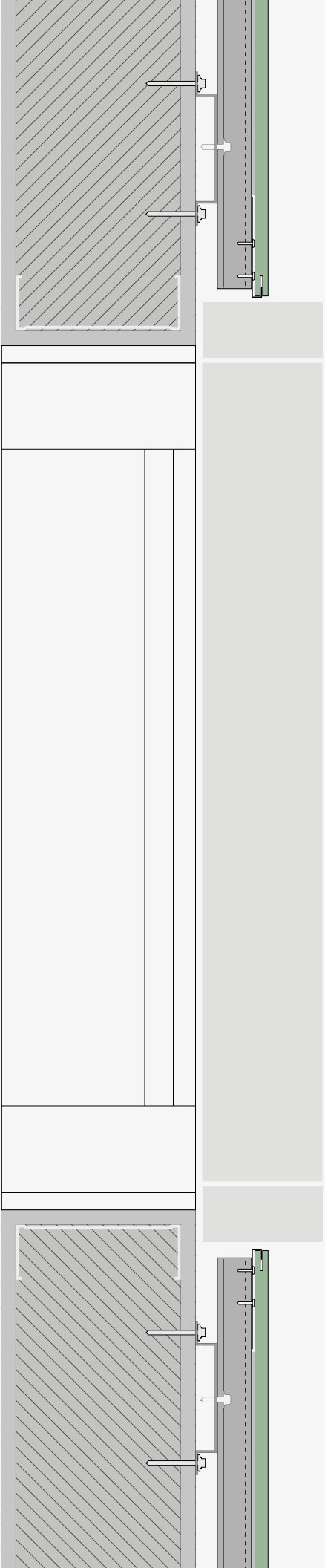
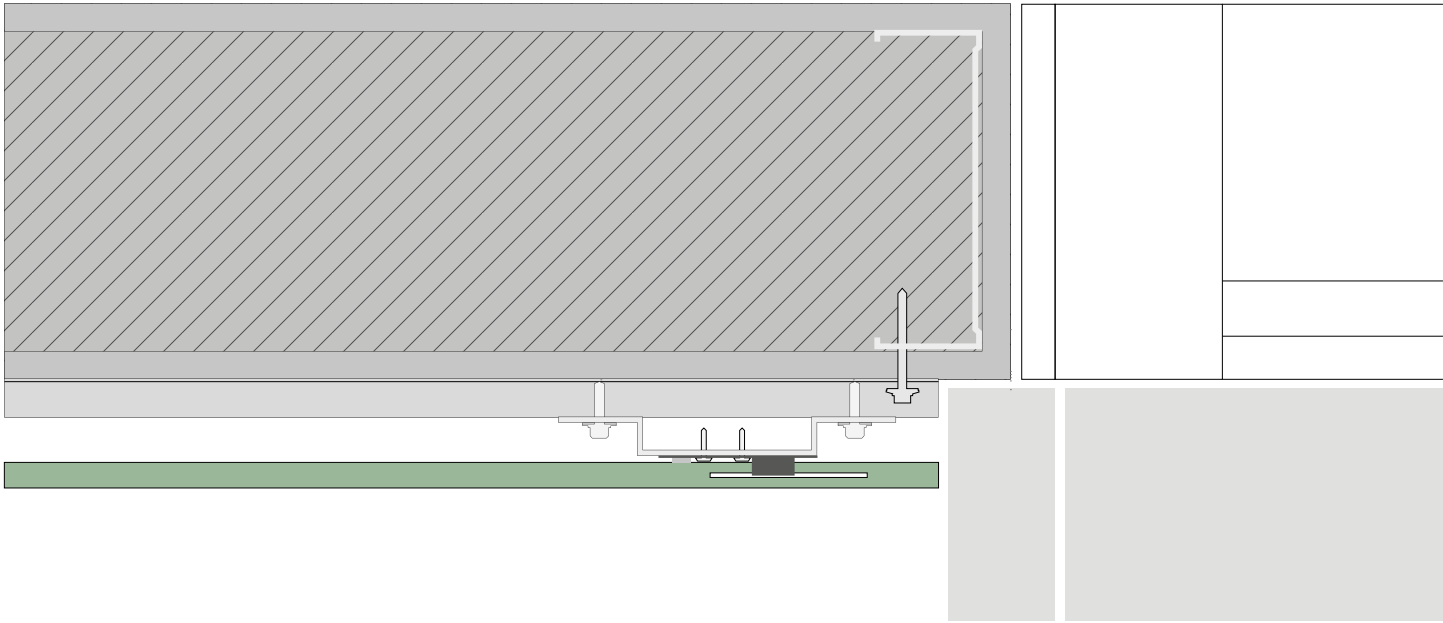

# Double Siding /SKS

## Horizontal Layout

Highlighting horizontal flow with clean lines, harmonious proportions, and a soothing rhythm created by precisely aligned porcelain panels.

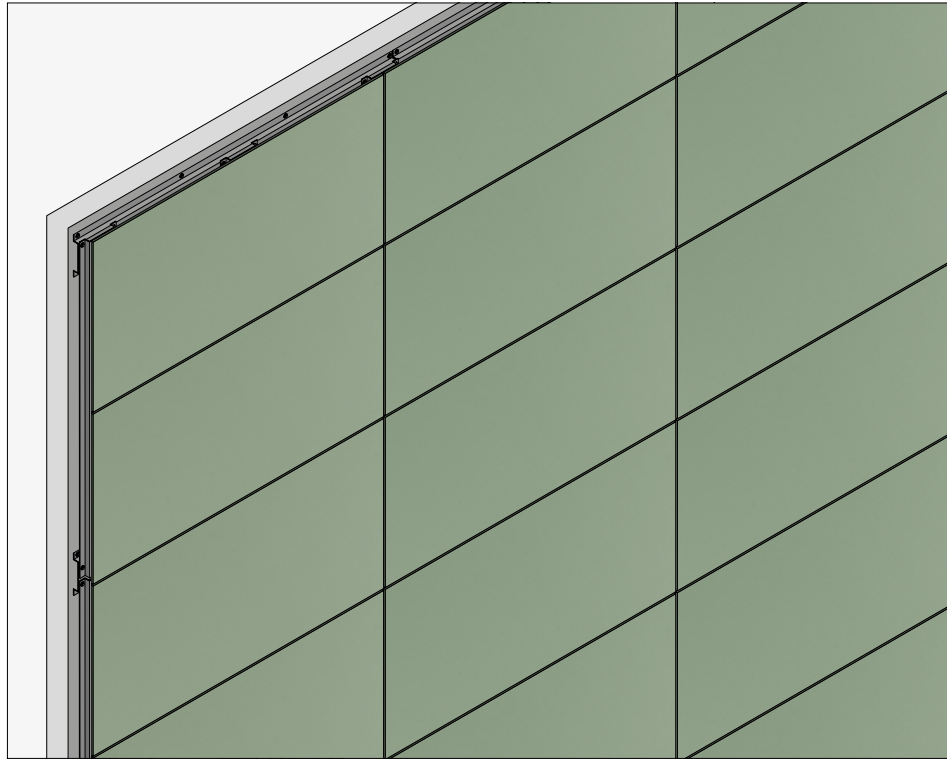

## Vertical Layout

Emphasizing verticality through sleek lines that elevate the design, imparting lightness and a refined, architectural rhythm.

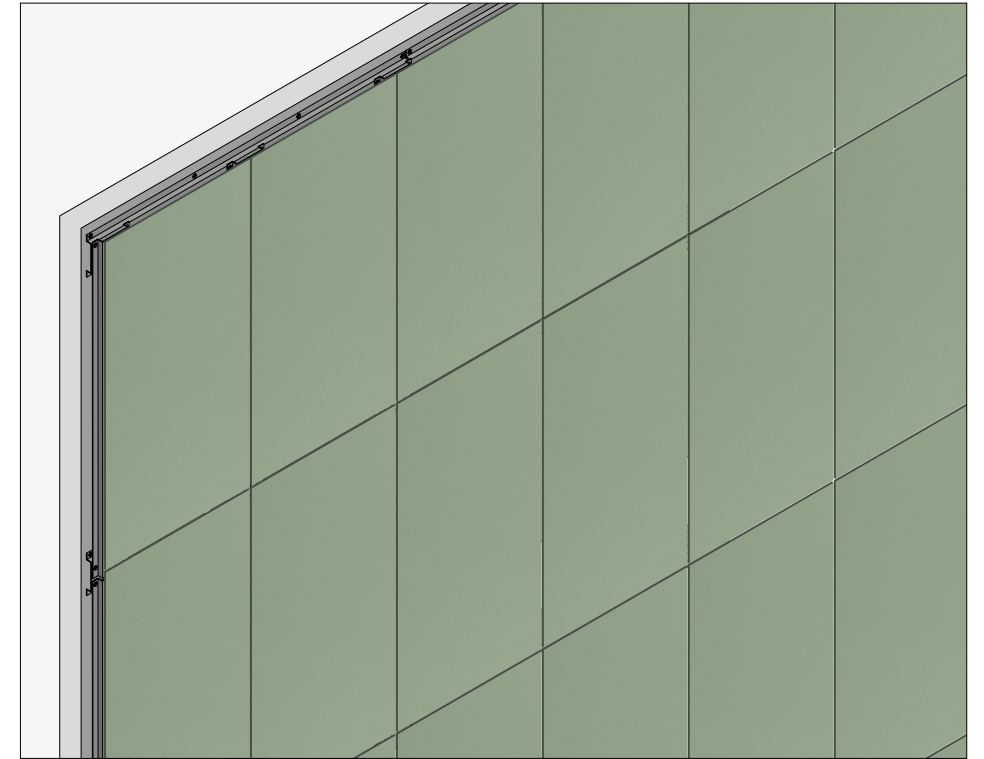

## Staggered Layout

Emphasizing movement with a dynamic rhythm and visual flow, enhanced by a modern, layered aesthetic.

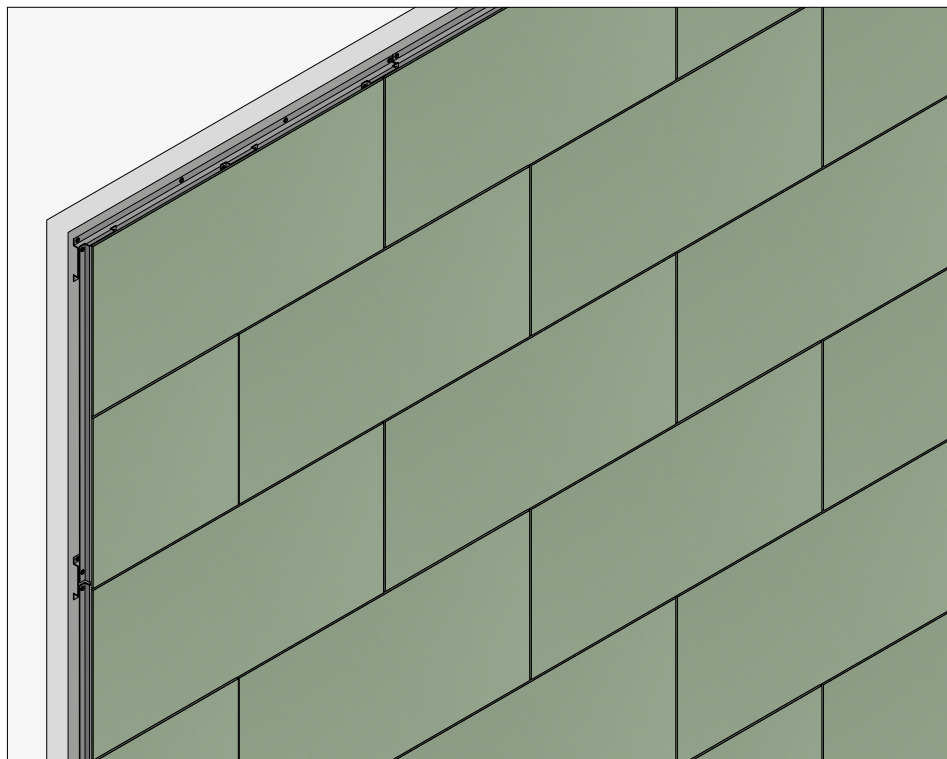

## Mixed Layout

Emphasizing joy and creativity through diverse patterns and an expressive, playful rhythm that invites creative freedom.

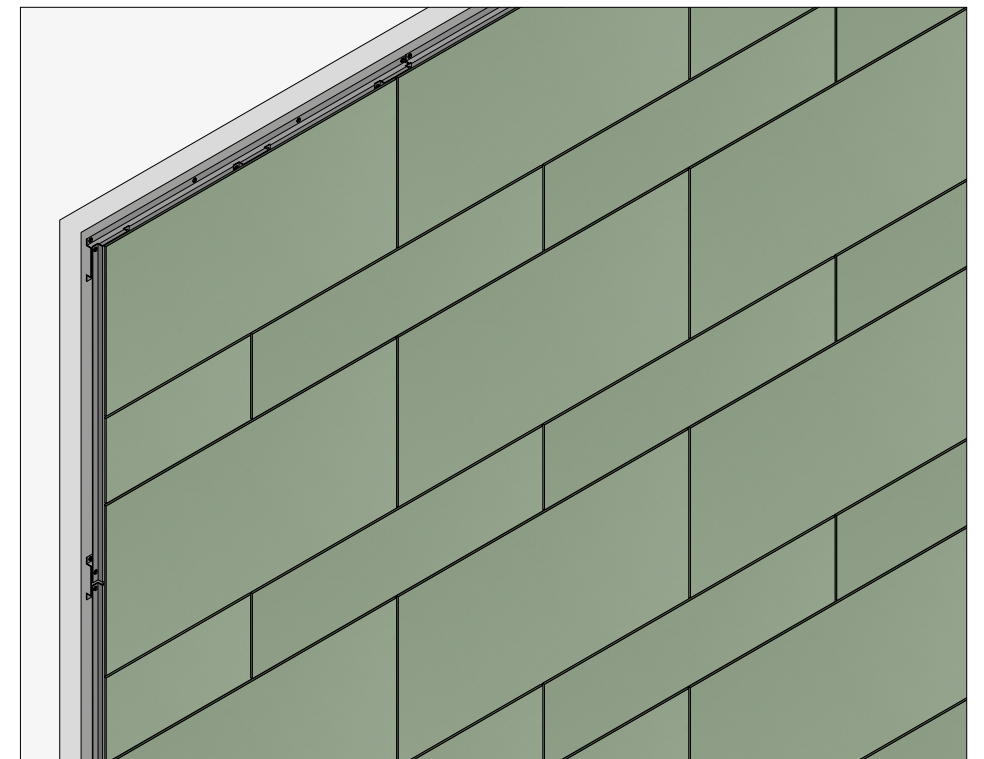





Get ahead to the  
design curve!

CONTACT US AT

---

1.866.FACHADA

OR EMAIL US AT

---

hello@porcelanosafacades.  
com

PORCELANOSA **FACADE/**