

PORCELANOSA FACADE/

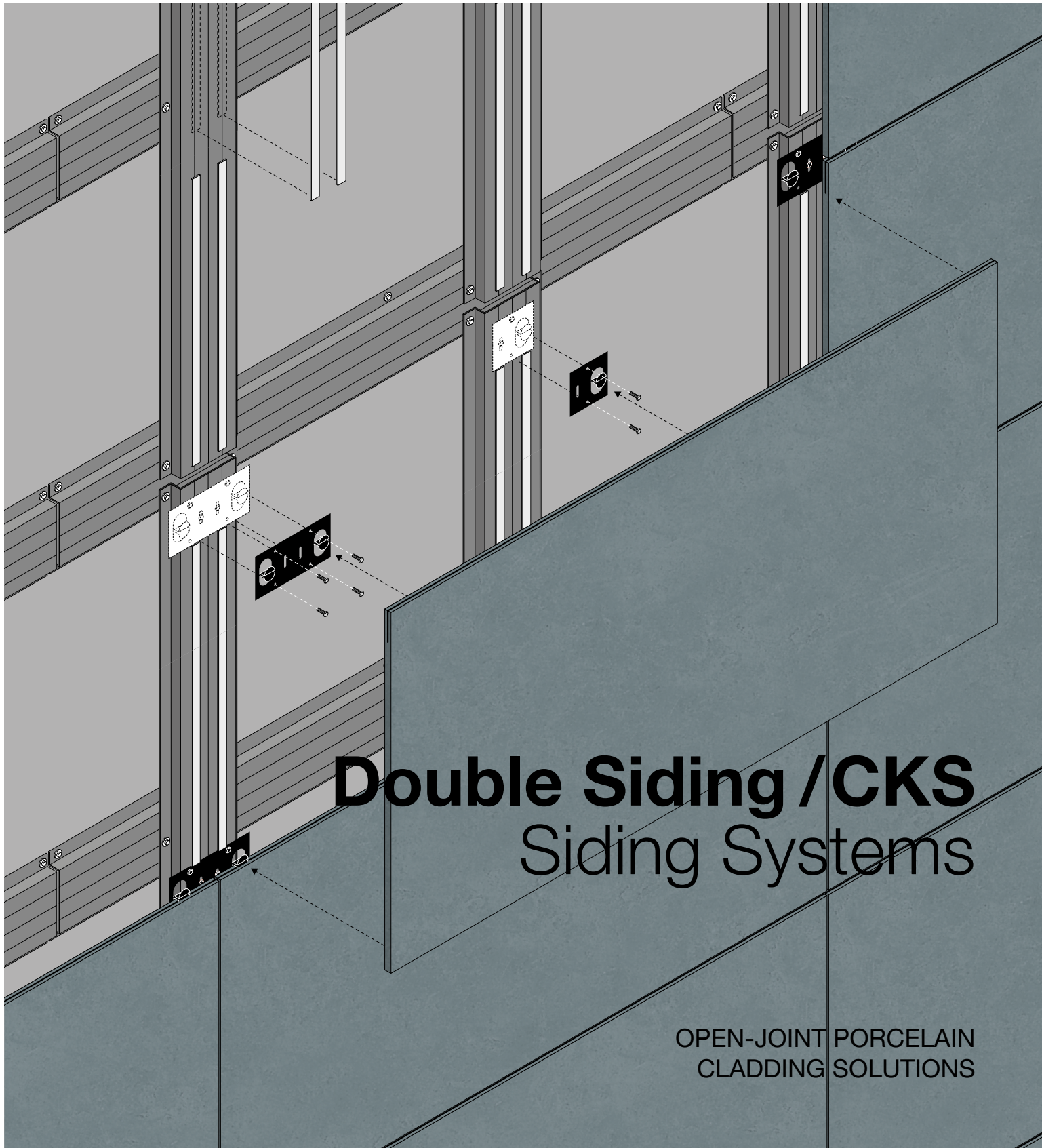

Double Siding / CKS Siding Systems

OPEN-JOINT PORCELAIN
CLADDING SOLUTIONS

Double Siding /CKS

Siding Systems

DESIGN YOUR VIEW BUILT YOUR DREAMS

Porcelanosa’s Siding Systems provide a façade solution using porcelain panels in pre-set size formats. Designed to streamline the build-up of the construction assembly, the DS (Double Siding) and CKS (Continuous Kerf System) offer versatile configurations for architects and design professionals.

A SIMPLE SYSTEM A REMARKABLE FAÇADE

The DS/CKS is a concealed mechanical-adhesive fixing system that uses a minimal substructure to reduce façade depth. Porcelanosa’s porcelain panels are secured using clips inserted into precise continuous kerfs cuts along their horizontal edges.

This system supports ventilated façades both with and without continuous insulation, adapting flexibly to project requirements.

Design your Porcelain Program +15,000 SF

CREATE A SIGNATURE LOOK FOR YOUR PROJECT

For façade designs exceeding **15,000 sf** in regular format panels, Porcelanosa offers the opportunity to co-design your own exclusive porcelain panels — a truly unique finish for landmark architecture. Bring your creative vision to life with personalized textures, tones, and dimensions.

WHY CHOOSE DS/CKS SYSTEM?

- Unlimited Finishes**

Porcelanosa offers a wide selection of porcelain textures and aesthetics.
- Simplicity**

Minimal build-up and fast, efficient installation.
- Concealed Fixing**

Invisible clips and Porcelanosa’s proprietary adhesive ensure a sleek, uninterrupted façade surface.
- Thermal Performance**

Compatible with non-insulated and insulated façades, including continuous insulation options for enhanced thermal efficiency.
- Long-Term Durability**

Engineered for resilience and performance in contemporary architecture.

Panel Sizes Available

Regular Format

PRE-SET SIZED MOLD TECHNOLOGY

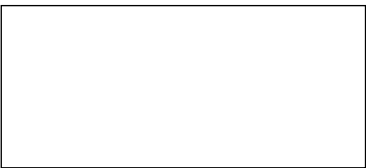

71” x 31”



71” x 24”



71” x 12”

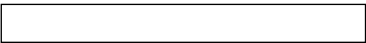

71” x 8”

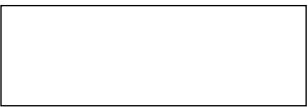

59” x 20”



59” x 10”



59” x 6”

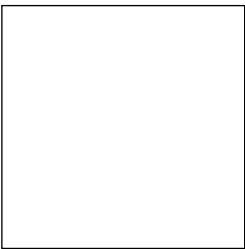

48” x 48”



48” x 24”



48” x 12”



48” x 8-6”

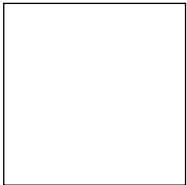

39” x 39”



39” x 20”



36” x 18”

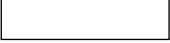

36” x 9”



36” x 6”

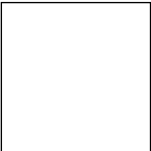

32” x 32”



32” x 16”



24” x 24”

Double Siding /CKS

Siding Systems

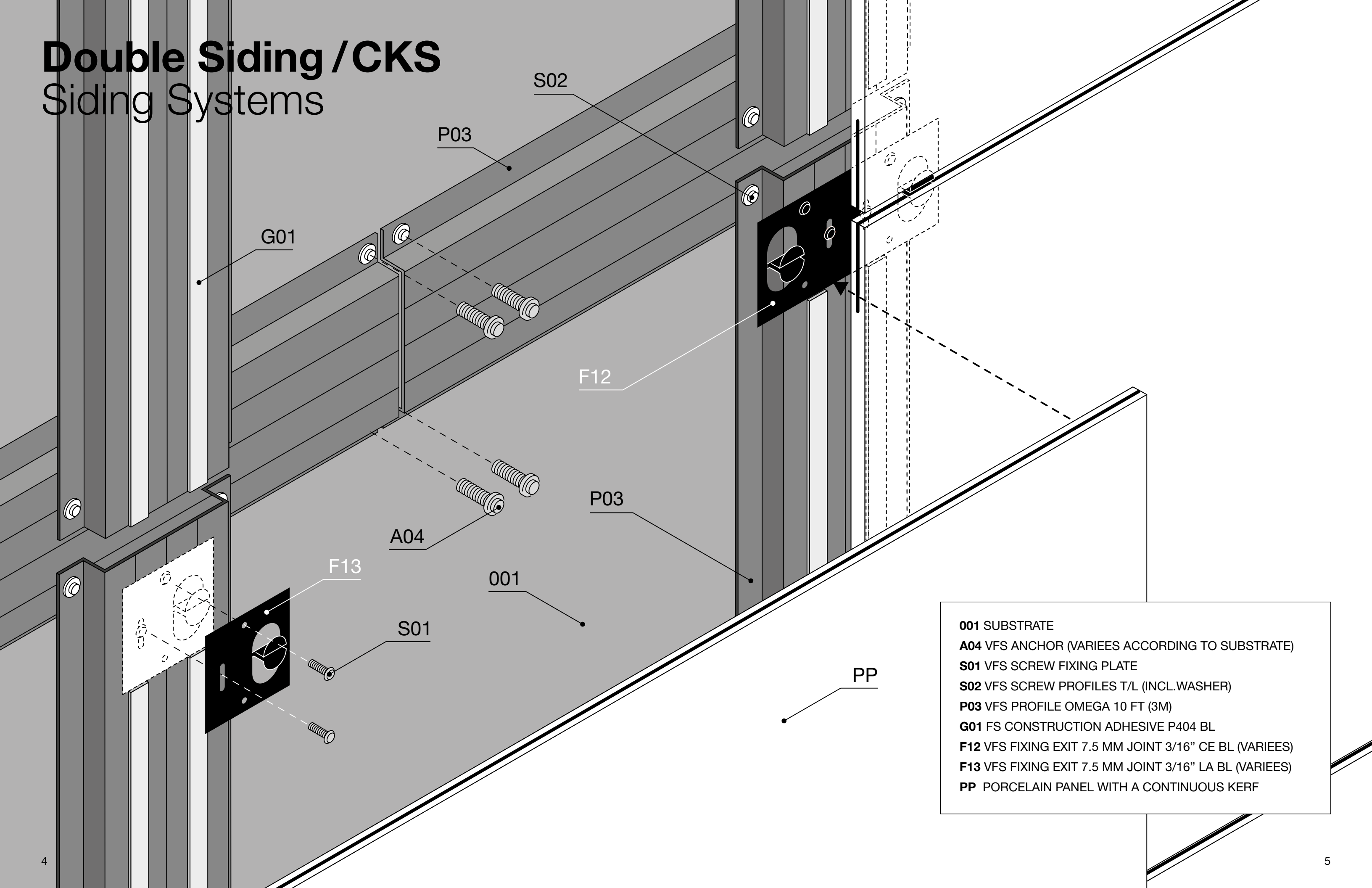

- 001** SUBSTRATE
- A04** VFS ANCHOR (VARIEES ACCORDING TO SUBSTRATE)
- S01** VFS SCREW FIXING PLATE
- S02** VFS SCREW PROFILES T/L (INCL.WASHER)
- P03** VFS PROFILE OMEGA 10 FT (3M)
- G01** FS CONSTRUCTION ADHESIVE P404 BL
- F12** VFS FIXING EXIT 7.5 MM JOINT 3/16" CE BL (VARIEES)
- F13** VFS FIXING EXIT 7.5 MM JOINT 3/16" LA BL (VARIEES)
- PP** PORCELAIN PANEL WITH A CONTINUOUS KERF

Double Siding /CKS

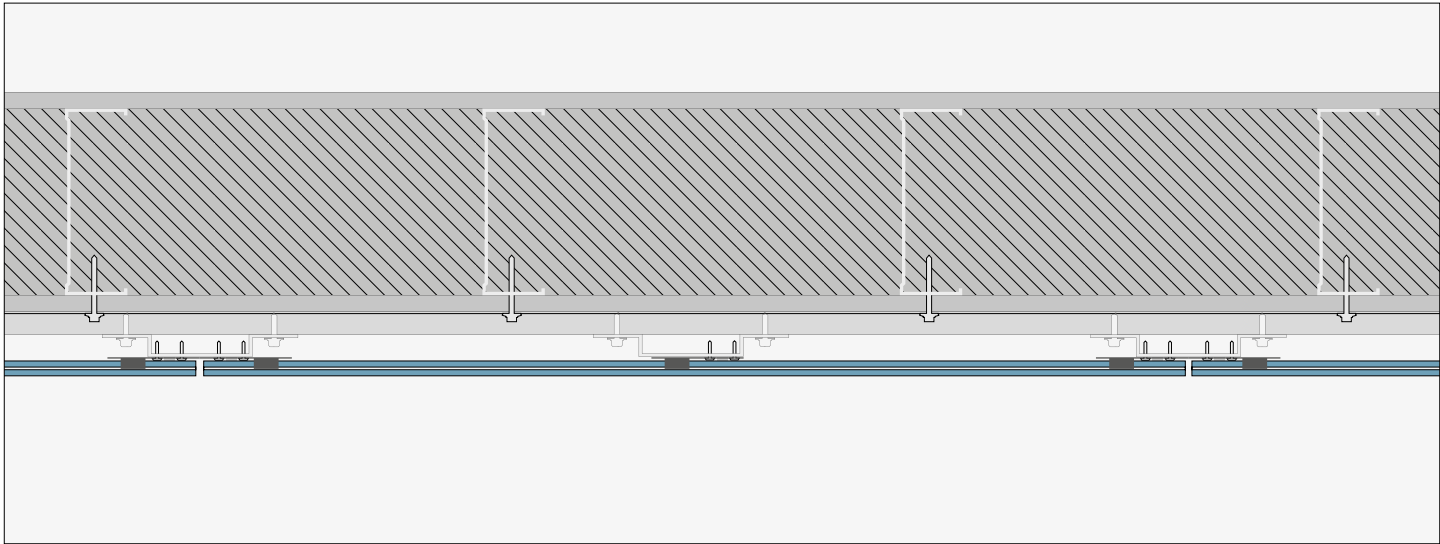

Horizontal Typical Detail.

SUBSTRUCTURE & BUILD-UP

The DS/CKS system features vertical and horizontal omegas, along with variable-depth fixing clips, tailored to panel thickness. The result is a minimized façade projection and a compact ventilated cavity.

Max./Min. build-up:

Standard configuration (no continuous insulation): 2-1/4" depth. With continuous insulation: Total depth increases based on insulation thickness.

Typical joints:

Standard vertical and horizontal joint: 3/16" (5 mm) or 5/16" (8 mm)

SOLID CONTINUOUS INSULATION SOLUTION

The system accommodates solid continuous insulation installed over the substrate. Fixings penetrate the insulation with minimal thermal bridging, delivering improved energy performance and envelope integrity.

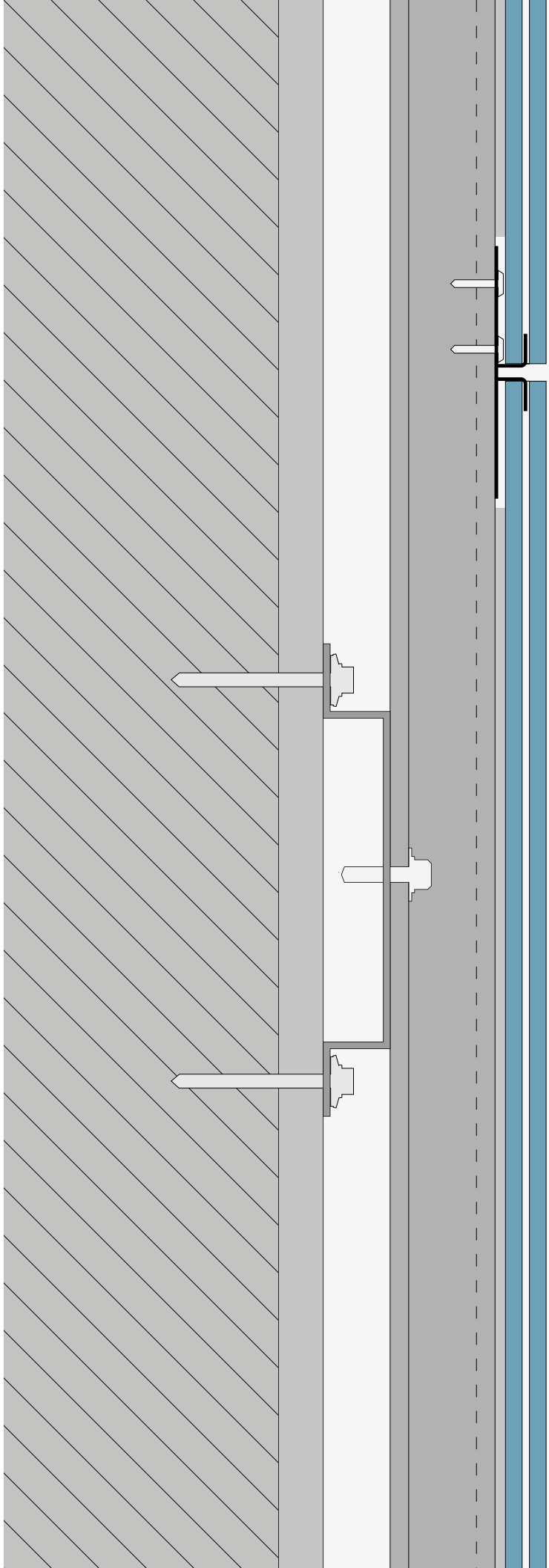
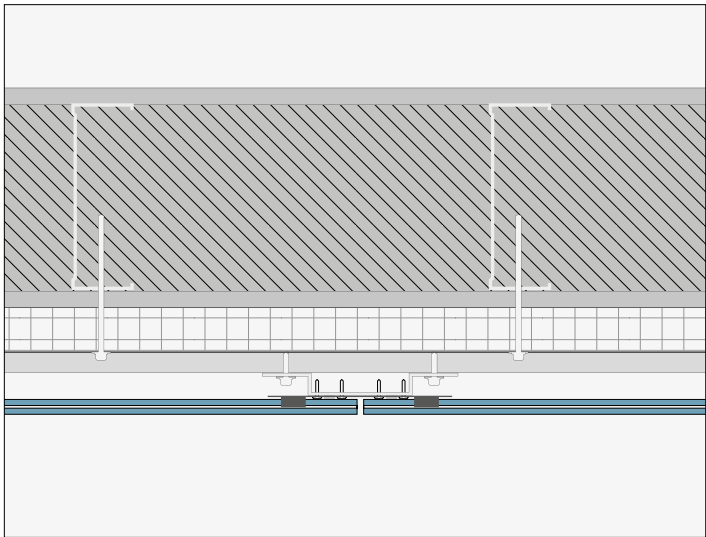

Vertical Typical Detail

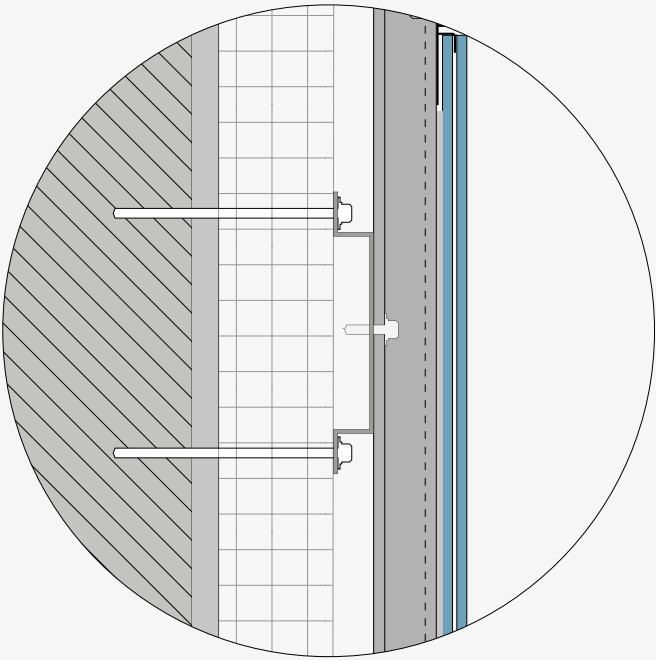

Double Siding /CKS

1

Installation of horizontal
omegas

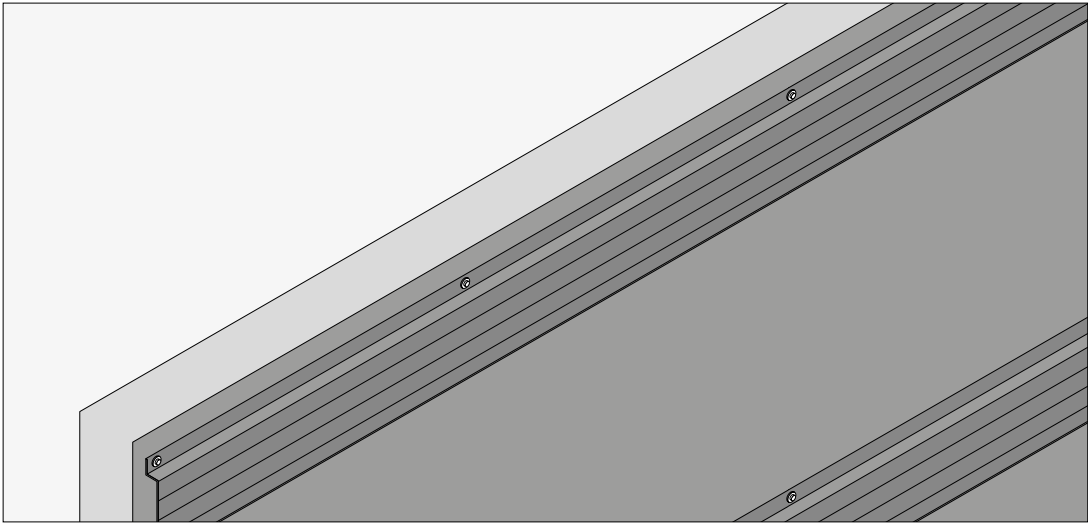

2

Installation of vertical
omegas aligned

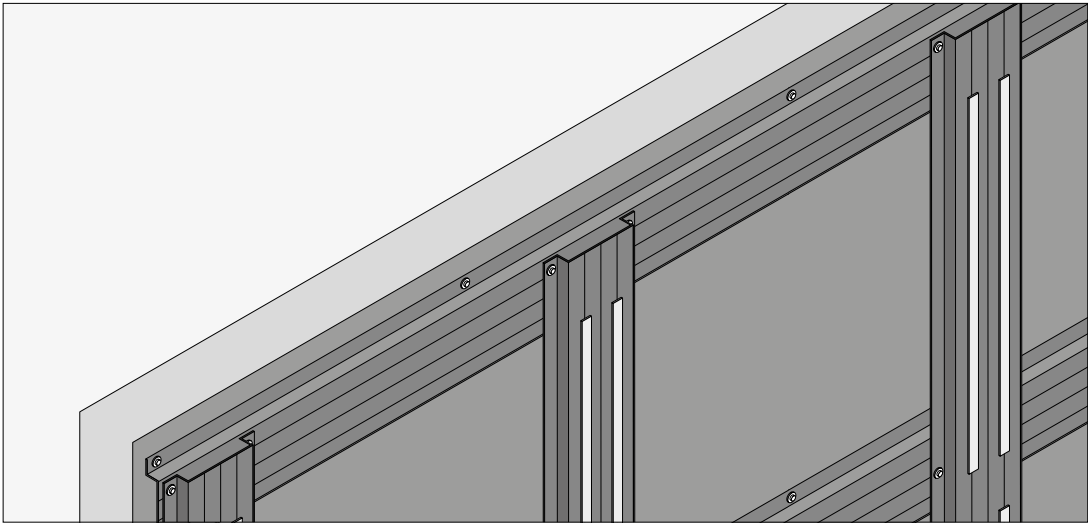

3

Installation of the first
clips/fixings

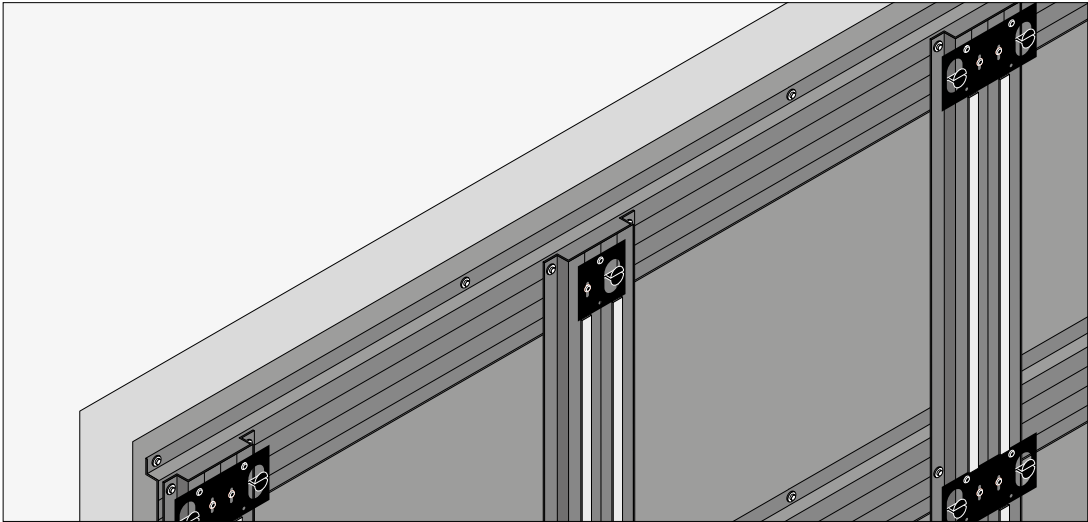

4

Installation of the porcelain panels
according to façade layout

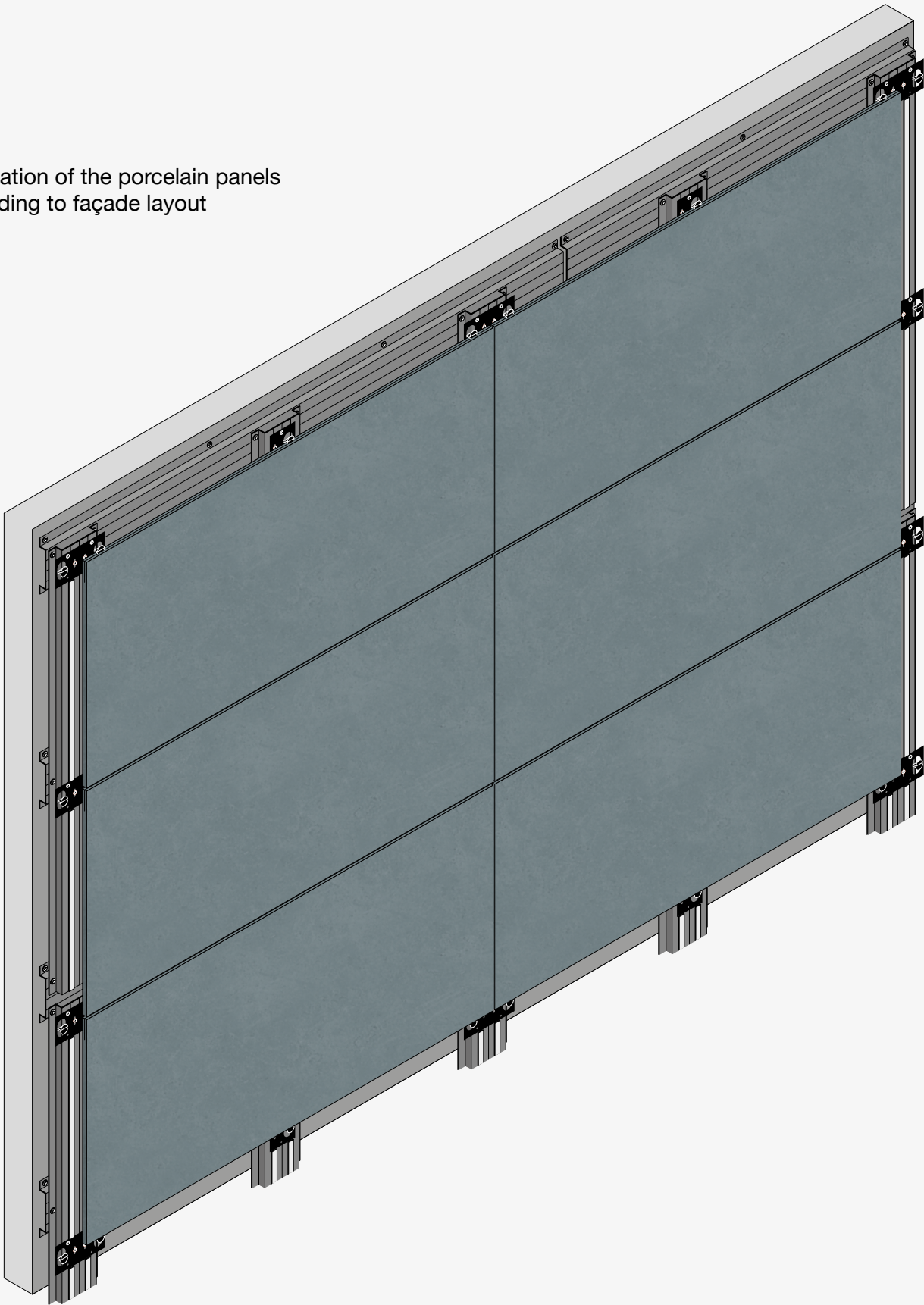

Double Siding /CKS

Every detail engineered —
Technical solutions for
external corners

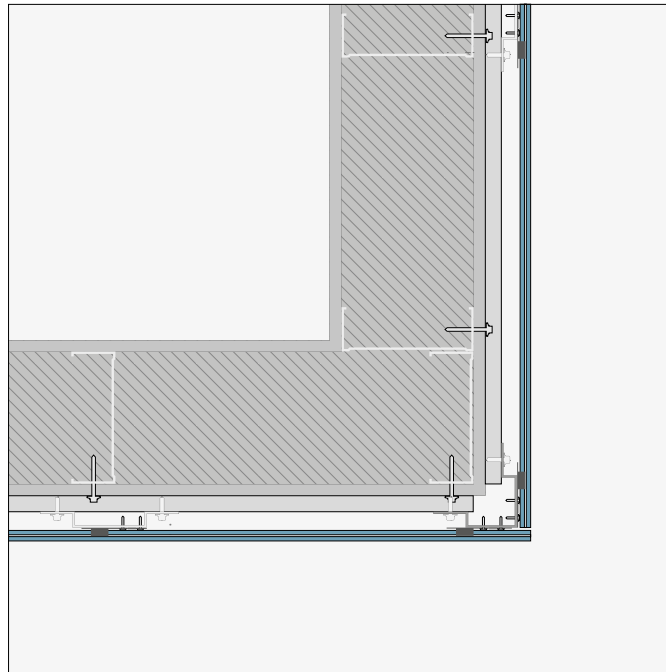

Outside Corner Detail

Every angle covered —
Technical solutions for
internal corners

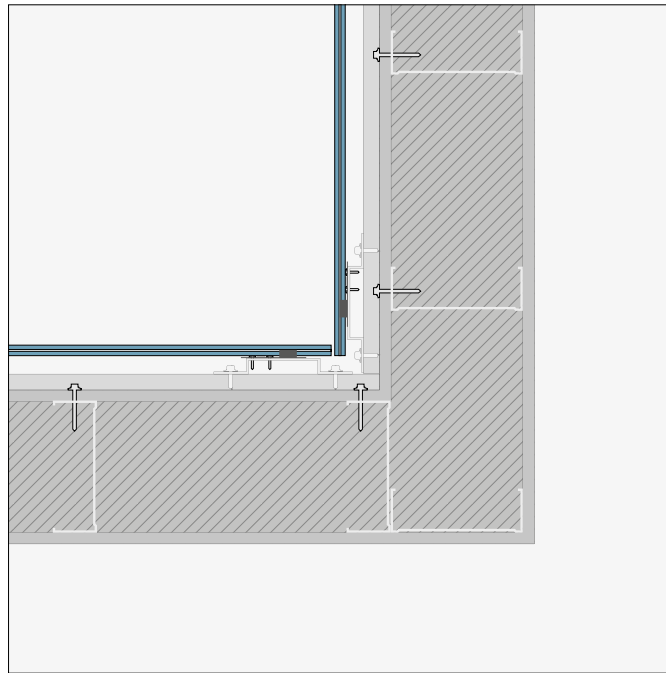

Inner Corner Detail

Type of Corners

Play and design with our different type of corners. Choose elegant solutions with the typical corner, mitered corners and recessed corners.

Recessed corners are ideal for seismic zones.

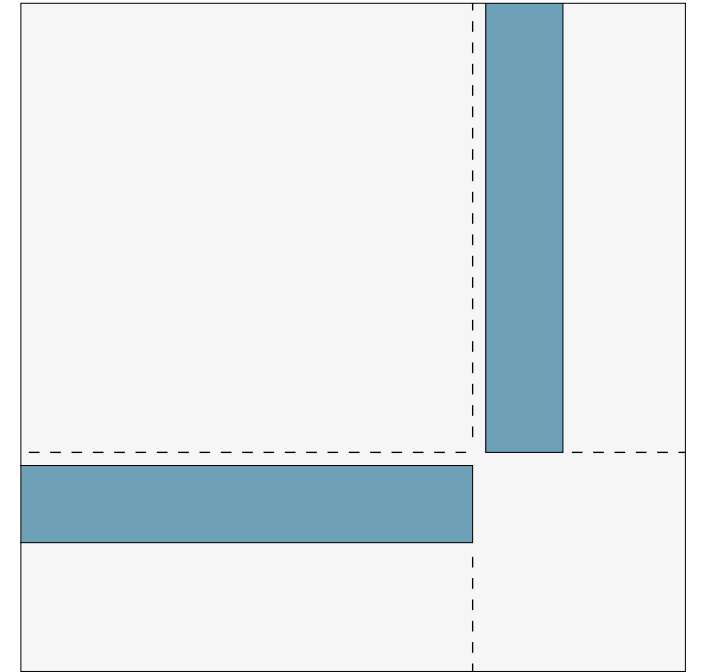

Recessed Corner

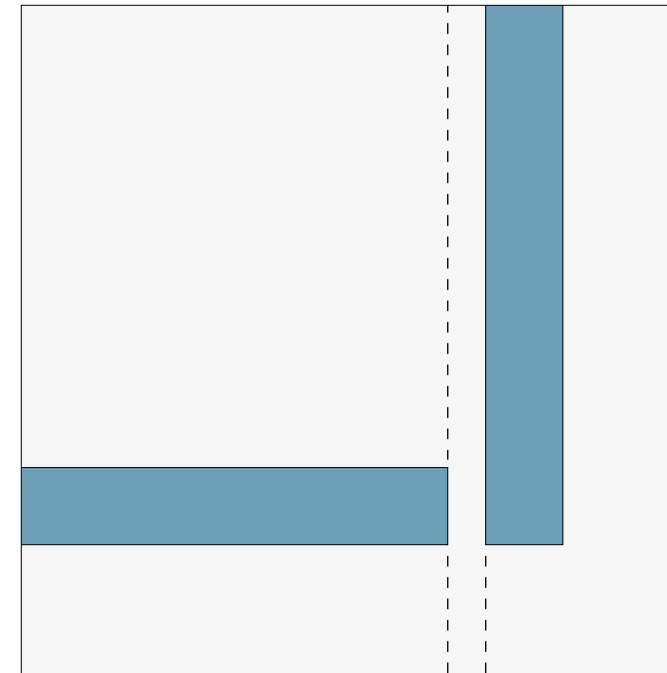

Typical Corner

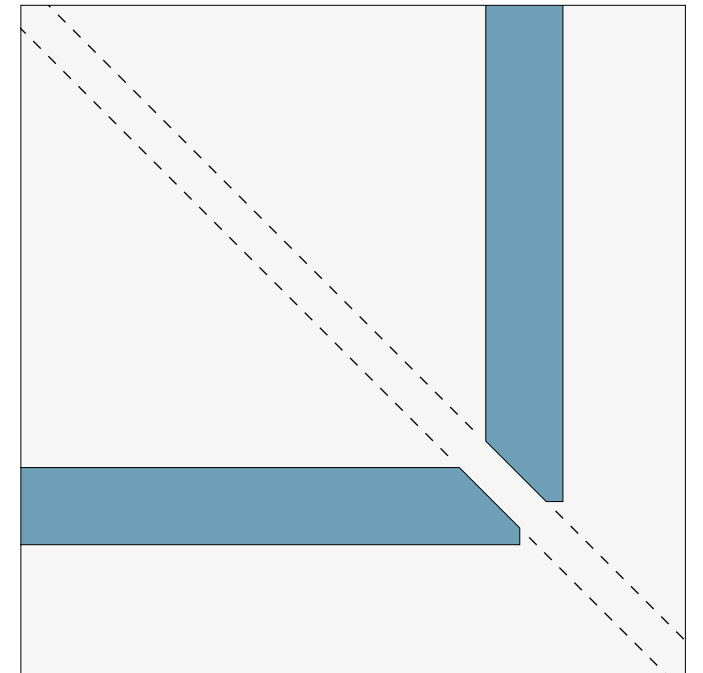

Mitered Corner

Double Siding /CKS

Siding Systems

Opening Solutions

Seamlessly integrate windows and frames with our façade systems to achieve custom, cohesive architectural designs.

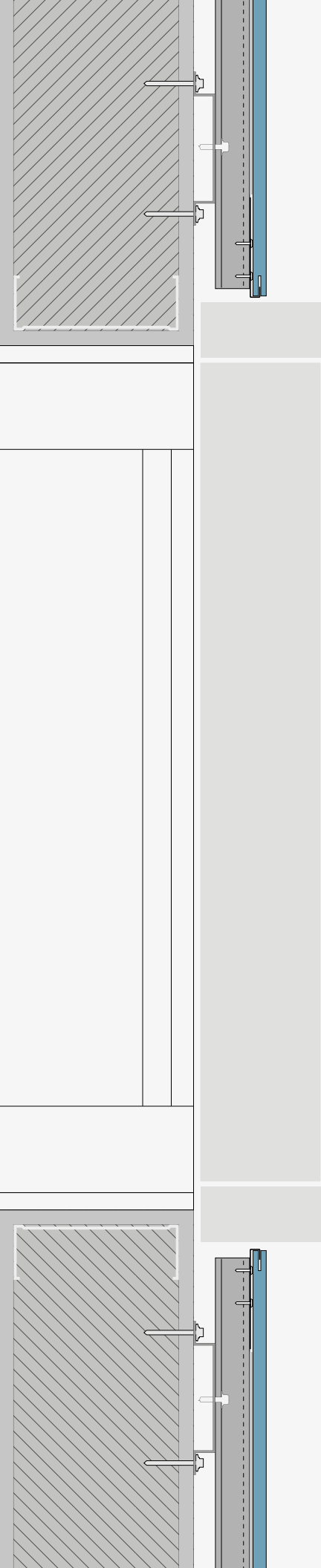
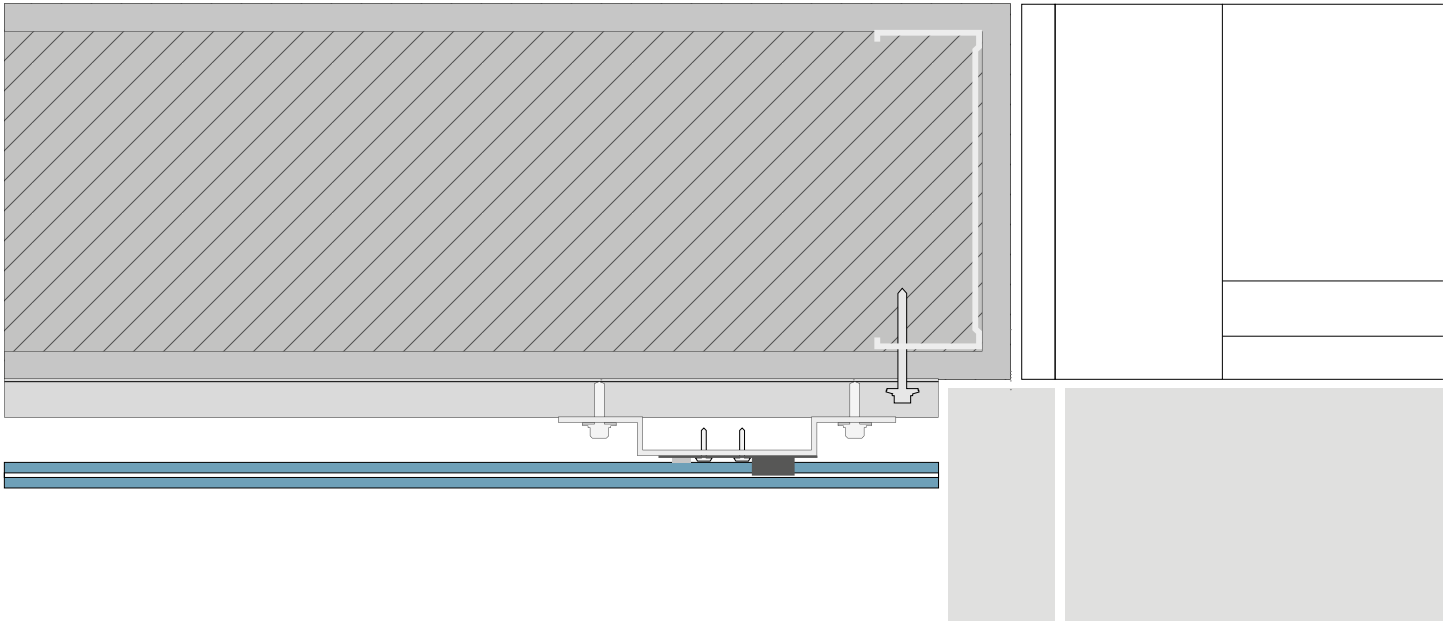

Double Siding /CKS

Optimized for Landscape Layouts

The CKS system is specifically designed to support landscape-oriented panel configurations. Its structure simplifies execution and enhances alignment, making it the ideal choice for achieving sleek, horizontal design lines with precision and efficiency.

Staggered Layout

Conveys motion through rhythmic layering and visual continuity, enriched by a dynamic, contemporary aesthetic.

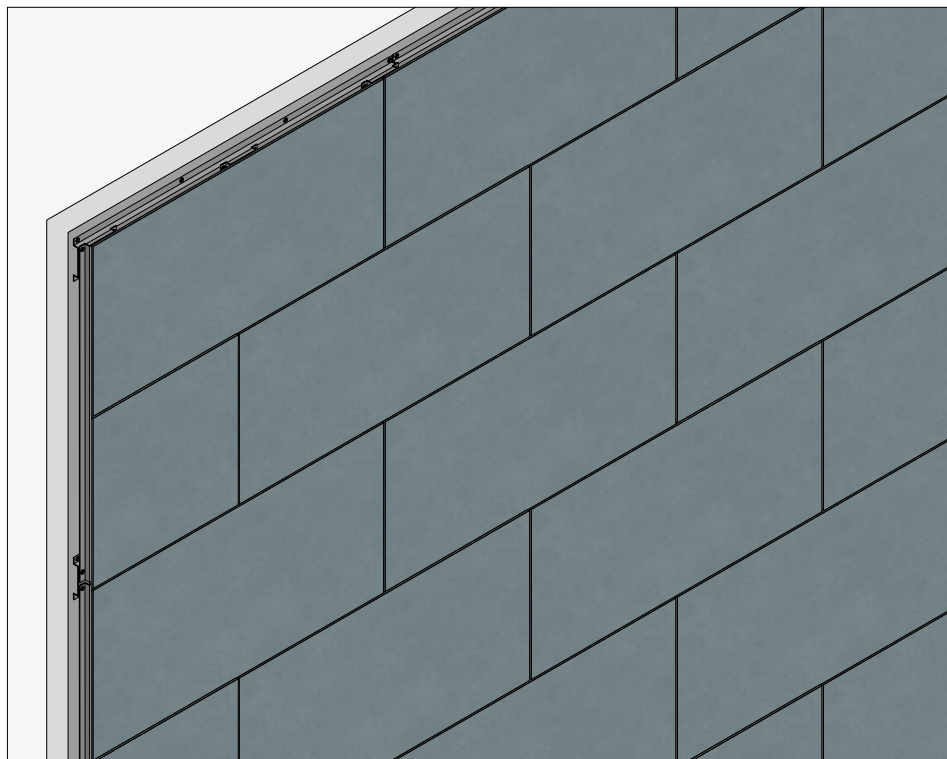

Horizontal Layout

Celebrates linear flow with clean geometry, balanced proportions, and a calm visual rhythm through perfectly aligned porcelain panels.

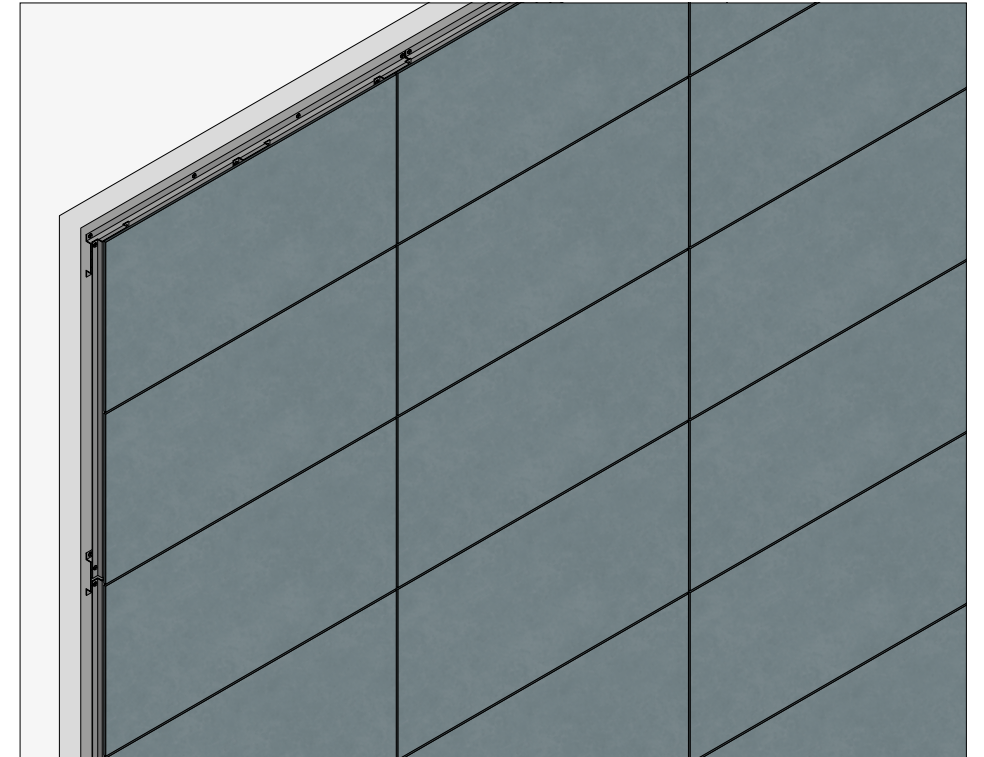

Mixed Layout

Inspires creativity through diverse patterns and expressive arrangements, encouraging playful and original compositions.

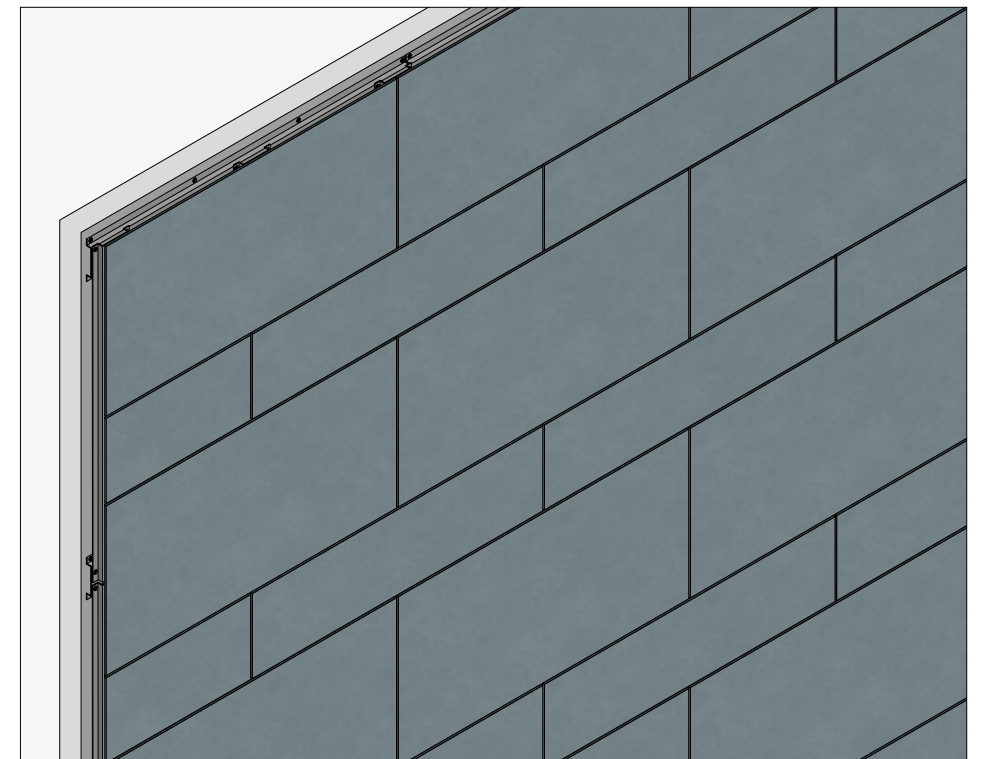



Get ahead to the
design curve!

CONTACT US AT

1.866.FACHADA

OR EMAIL US AT

hello@porcelanosafacades.
com

PORCELANOSA **FACADE/**